



Quick Start Guide

VGA CAT5e/6 Extender Kit

GVE130
PART NO. Q1126

Package Contents

- 1 x VGA Extender (Local Unit)
- 1 x VGA Extender (Remote Unit)
- 1 x 6ft VGA Male to Female Cable
- 2 x Power Adapter
- 1 x Quick Start Guide
- 1 x Warranty Card

SJ/T 11363-2006

The following contains information that relates to China.



部件名称	有毒有害物质或元素					
	铅 (Pb)	汞 (Hg)	镉 (Cd)	六价 (Cr(VI))	多溴联苯 (PBB)	多溴二苯醚 (PBDE)
电器部件	●	○	○	○	○	○
机构部件	○	○	○	○	○	○

○: 表示该有毒有害物质在该部件所有均质材料中的含量均在 SJ/T 11363-2006规定的限量要求之下。

●: 表示符合欧盟的豁免条款，但该有毒有害物质至少在该部件的某一均质材料中的含量超出 SJ/T 11363-2006的限量要求。

x: 表示该有毒有害物质至少在该部件的某一均质材料中的含量超出SJ/T 11363-2006的限量要求。

Local Unit

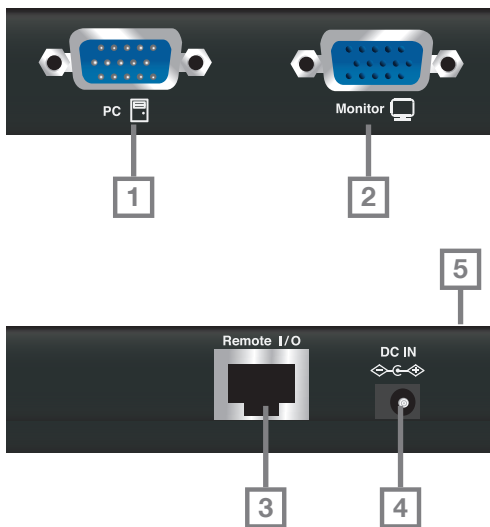

1. VGA Input Port
2. VGA Output Port
3. Extension Input/Output Port
4. DC Power Jack
5. Power LED

Remote Unit

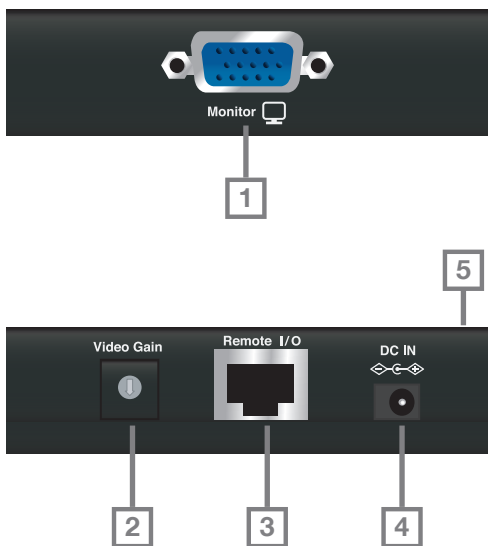

1. VGA Output
2. Video Gain Control Switch
3. Extension Input/Output Port
4. DC Power Jack
5. Power LED

Installation

Note: Make sure your source device and all displays are powered off before you start.

Step 1

Plug the power adapter to the power outlet and the power jack of the VGA Extender (Both Local and Remote Unit)

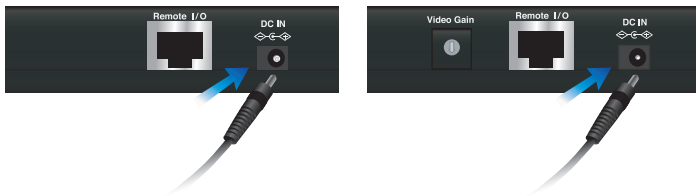

Step 2

Connect a provided VGA extension cable (Male to Female) between your video source's output (Male connector from the cable) and the local unit of the VGA extender's input port (Female connector from the cable)

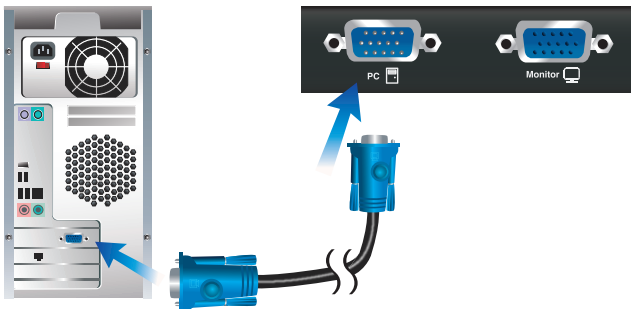

Step 3

Connect VGA Male to Male cables between your displays' input ports and VGA extender's output ports (Both Local and Remote Unit). We suggest using two equivalent model of display on local and remote unit to ensure the user experience.

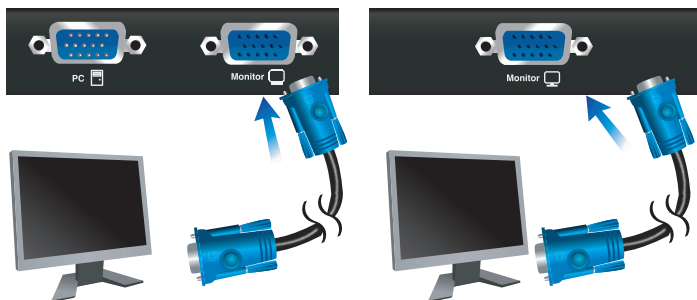

Step 4

Connect a solid CAT5e/6 cable between the local and remote unit of the Extension Input/Output Port

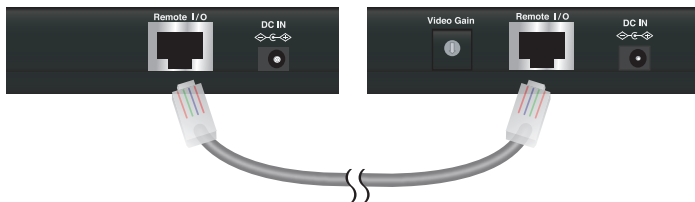

Final Step

Turn on your source device and displays

Video Gain Control Switch*

Setting	CAT5e/6 Cable Length (meters)
0	No longer than 150
1	140-150
2	130-140
3	120-130
4	110-120
5	100-110
6	90-100
7	80-90
8	70-80
9	60-70
A	50-60
B	40-50
C	30-40
D	20-30
E	10-20
F	0-10

*Setting may vary depending on different CAT cables. Please use the suggested setting for a reference and fine tune the setting if needed.

Warranty

WE'RE HERE TO HELP YOU! NEED ASSISTANCE SETTING UP THIS PRODUCT?

Make sure you:

1. Use the live chat at www.iogear.com to try and solve any issues you may be having with the product
2. Visit the Tech Info Library/FAQ on www.iogear.com (under the Support tab)
3. Call the tech support line at 1(866) 946-4327 (U.S. only) or (949) 453-8782

Warranty Information

This product carries a 3 Year Limited Warranty. For the terms and conditions of this warranty, please go to

<http://www.iogear.com/support/warranty> or call 1-866-946-4327

Register online at <http://www.iogear.com/register>

Important Product Information

Product Model _____

Serial Number _____

Contact

IOGEAR Inc.

Address: 19641 Da Vinci, Foothill Ranch, CA 92610 USA

Toll Free: 866-9-IOGEAR

Phone: 949-453-8782

Web site: www.iogear.com

Email: support@iogear.com



About Us



FUN

IOGEAR offers connectivity solutions that are innovative, fun, and stylish, helping people enjoy daily life using our high technology products.



GREEN

IOGEAR is an environmentally conscious company that emphasizes the importance of conserving natural resources. The use of our technology solutions helps reduce electronic waste.