

FCC Statement

This equipment has been tested and found to comply with the limits for a Class B digital device, pursuant to Part 15 of the FCC Rules. These limits are designed to provide reasonable protection against harmful interference in a residential setting. This product generates, uses, and can radiate radio frequency energy and, if not installed and used as directed, it may cause harmful interference to radio communications. Although this product complies with the limits for a Class B digital device, there is no guarantee that interference will not occur in a particular installation.

CE Compliance

This device has been tested and found to comply with the following European Union directives: Electromagnetic Capability (89/336/EMC), Low Voltage (73/23/EEC) and R&TTE (1999/5/EC).

Limited Warranty

WE'RE HERE TO HELP YOU! NEED ASSISTANCE SETTING UP THIS PRODUCT?

Make sure you:
1. Use the live chat at www.iogear.com to try and solve any issues you may be having with the product
2. Visit the Tech Info Library/FAQ on www.iogear.com (under the Support tab)
3. Call the 24/7 tech support line at 1-866-946-4327 (U.S. only) or 1-949-453-8782

Warranty Information
This product carries a 3 Year Limited Warranty. For the terms and conditions of this warranty, please go to <http://www.iogear.com/support/warranty> or call 1-866-946-4327

Register online at <http://www.iogear.com/register>

Important Product Information

Product Model _____
Serial Number _____

Contact

IOGEAR Inc.
Address: 19641 Da Vinci, Foothill Ranch, CA 92618 USA
Toll Free: 866-94IOGEAR
Phone: 949-453-8782
Web site: www.iogear.com
Email: support@iogear.com



Quick Start Guide

2.4GHz Wireless On-Lap Keyboard with Optical Trackball and Scroll Wheel

Package Contents

1 x 2.4GHz On-Lap Keyboard
1 x USB RF Receiver
2 x AA NiMH Rechargeable Battery
1 x USB Charging Cable
1 x Quick Start Guide
1 x Warranty Card

Requirements

Computer / Device*

- 1 USB port

Operating System

- Windows XP
- Windows Vista (32-bit / 64-bit)
- Windows 7 (32-bit / 64-bit)
- Mac OS X v10.3.9 or later**

*Device must support USB HID keyboard device and USB HID-compliant mouse in order to have the keyboard and mouse functionality respectively.

** Some Mac special keys may not work

© 2010 IOGEAR, INC.

GKM581R
Q1139

Overview

Start Here!

Keyboard – Front View

1. Mouse Left-Click
2. Mouse Right-Click
3. Default Homepage
4. E-mail
5. My Computer
6. Back
7. Forward
8. Close
9. LED
10. Play/Pause
11. Stop
12. Previous Track
13. Next Track
14. Mute
15. Volume Down
16. Volume Up
17. Optical Trackball



Keyboard – Side View

1. Mouse Left-Click
2. Connect Button
3. USB Charging Port
4. Rapid Fire/Normal Mode Switch
5. Scroll Wheel

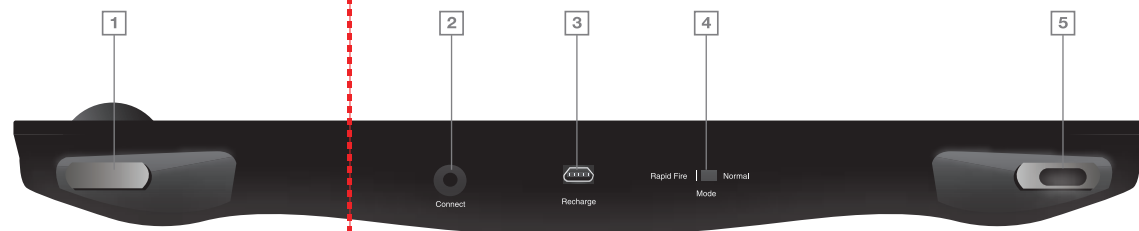

Keyboard – Bottom View

1. Battery Cover



USB RF Receiver

1. USB connection
2. LED

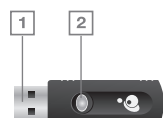

Installation

STEP 1

Open the battery cover from the bottom of the keyboard and take the USB RF receiver out. Then, insert the 2 included AA rechargeable batteries into the battery tray* and close the battery cover.

*Please make sure the batteries are installed properly as the directions inside the battery tray.

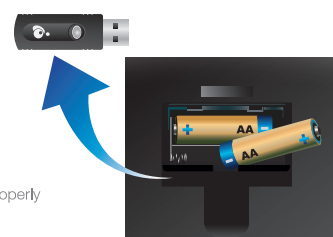

STEP 2

Connect the USB RF receiver into any open USB port of your computer/device*.

*Device must support USB HID keyboard device and USB HID-compliant mouse in order to have the keyboard and mouse functionality respectively.



FINAL STEP

Now the keyboard setup is completed and ready for the initial charge before use, please see the Charging section for detail.

Charging

Note: The rechargeable batteries need to be fully charged before use. The initial charge will take approximately 6 hours.

Connect the included USB charging cable to the USB charging port from the keyboard and the USB port of your computer/device* to charge. The Battery Low LED will show in solid red indicating the keyboard is being charged**. The LED will show in solid green once the keyboard is fully charged, then you can remove the USB charging cable.

*Computer/device must be powered on

**Keyboard can be used while being charged (Not recommended for initial charge)



Pairing (Optional)

The keyboard and mouse should be working properly without the need to pair. If the keyboard and mouse are not working, please follow the below instruction to pair the USB RF receiver and the keyboard.

Note: Please keep the distance between the keyboard and USB RF receiver as close as possible when pairing. The keyboard will connect to the closest USB RF receiver if there are more than 1 set of this keyboard within the same area.

Press the Connect button on the top side of the keyboard while the USB RF receiver is connected to the computer/device*. The LED on the USB RF receiver will flash in blue for 1-3 seconds indicating the pairing is completed.

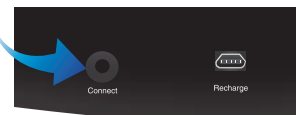

* Computer/device must be powered on

Now the keyboard and mouse should be working properly. If the keyboard and mouse are not working, please repeat the above instruction.

Sleep Mode

After the keyboard is idle for 8 minutes, it will go into sleep mode to save power. To wake it up, simply press the mouse left-click or right-click button.

Rapid Fire/Normal Mode Switch

Slide the switch to either left or right to choose from different mode settings

| Mode | Switch | Description |
|------------|--------------------|---|
| Normal | Slide to the right | Press left-click key to perform single left-click |
| Rapid Fire | Slide to the left | Press and hold left-click key to perform rapid fire |

LED Indication

| LED | Description |
|--------------|---|
| Solid Green | Batteries are fully charged |
| Solid Red | Batteries are being charged |
| Flashing Red | Power is low and the batteries need to be recharged |