



## Quick Start Guide

### 4K Video Extender/Splitter Over CAT6 Kit Transmitter and Receiver

GVE4K60KIT  
PART NO. Q1689

www.iogear.com

## Package Contents

- |                                 |                       |
|---------------------------------|-----------------------|
| 1 x Transmitter                 | 4 x Mounting brackets |
| 1 x Receiver                    | 12 x Screws           |
| 2 x Power Adapters              | 1 x Quick Start Guide |
| 1 x IR blaster extension cable  | 1 x Warranty Card     |
| 1 x IR receiver extension cable |                       |

## System Requirements

- HDMI source device with HDMI output port (computer graphics card, DVD, PS3, HD monitoring equipment, etc).
- HDMI display device like SDTV, HDTV, projector with HDMI input port.
- STP CAT6 or better quality cable. Follow standard IEEE-5688, it is recommended to select a solid core network cable for connection integrity.

## Introduction

This HDMI Extender includes a transmitter unit and a receiver unit which allows HDMI signals to be transmitted up to 70 meters at 4K resolution using a CAT6 or better quality network cable. It is perfect for outdoor advertising, video clips, monitor system, home entertainment, and conference, etc.

## Overview

### Transmitter

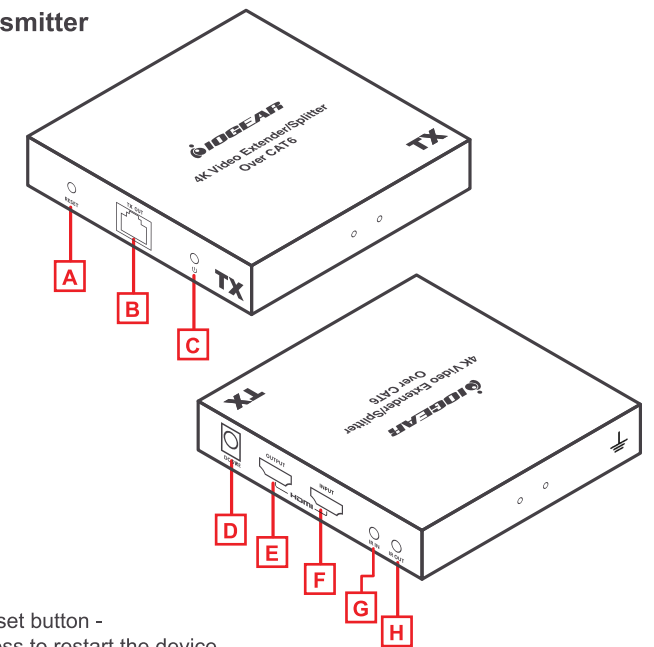

- A. Reset button - Press to restart the device
- B. RJ45 signal output - Connect to network cable
- C. Power/Signal indicator - When there is power and no HDMI signal, the indicator will flash, when there is HDMI signal, the indicator will light solid blue
- D. DC 5V input - Connect to DC 5V/2A power adapter
- E. HDMI output - Connect to HDMI display device
- F. HDMI input - Connect to the source device

## Overview

### Receiver

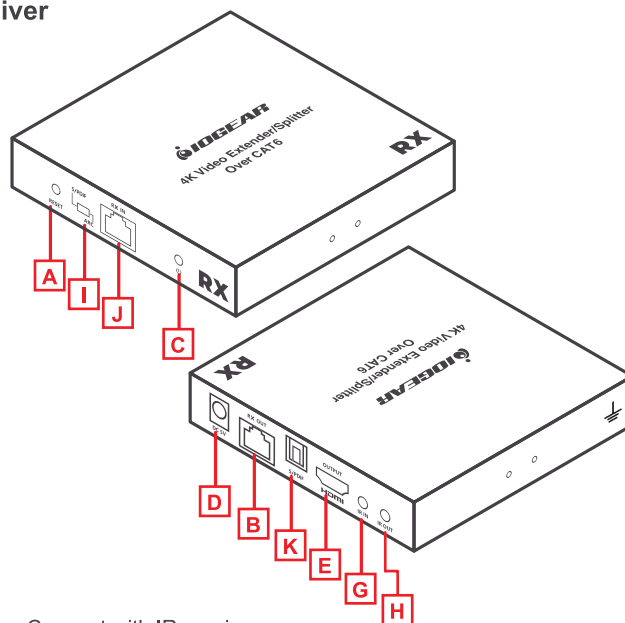

- G. IR in - Connect with IR receiver extension cable, please make sure the remote control used is within the effective range
- H. IR out - Connect with IR blaster extension cable, please get closer to the source device while using
- I. Audio switch - Choose to decode audio from HDMI or ARC output from fiber optic interface
- J. RJ45 signal input - Connect with network cable
- K. S/PDIF out - Output digital audio signal

## Hardware Installation

Follow the standard of IEEE-568B, it is recommended to select a network cable with less loss and crosstalk.

- |                    |            |                   |           |
|--------------------|------------|-------------------|-----------|
| 1 - Orange / white | 2 - Orange | 3 - Green / white | 4 - Blue  |
| 5 - Blue / white   | 6 - Green  | 6 - Brown / white | 6 - Brown |

### Instruction

1. Connect the source device to the HDMI in port of the transmitter with an HDMI cable

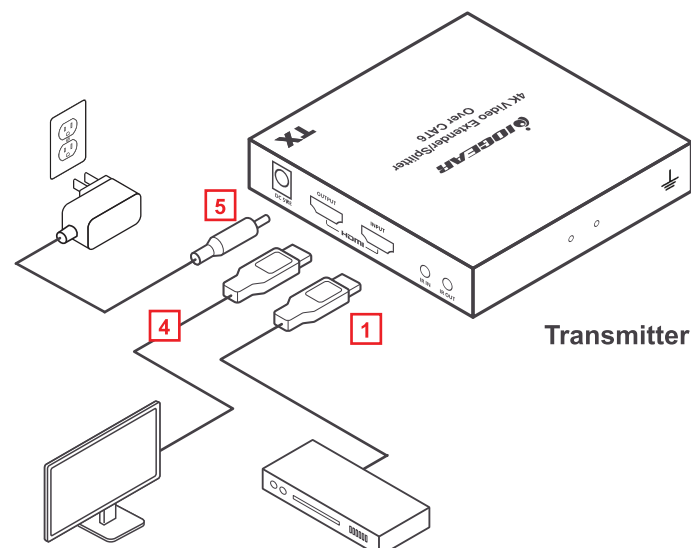

## Hardware Installation

2. Connect the HDMI out port of the receiver to the display device with another HDMI cable.

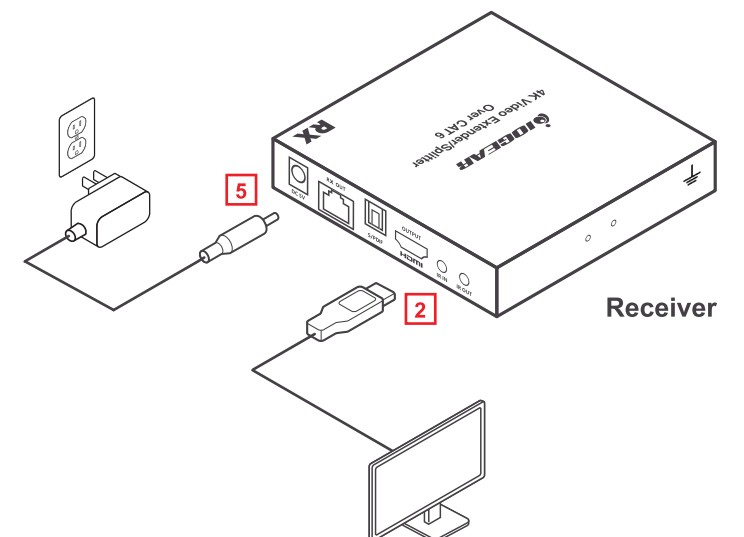

## Hardware Installation

3. Connect the CAT out port of the transmitter and the CAT in port of the receiver via a network cable (CAT6 or better quality cable). If cascading is used, connect the CAT out port of the previous receiver to the CAT in port of the next receiver.
4. If using HDMI loop out, connect the display device to the HDMI OUT port of the transmitter.
5. Plug the power adapter cable into the power jack on both GVE4K60 units.

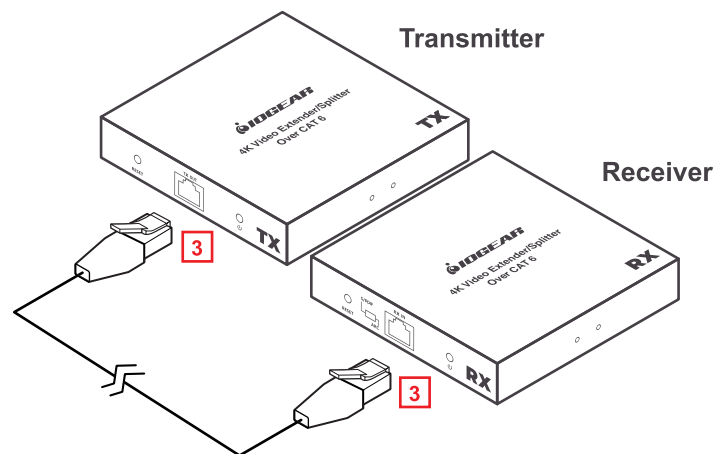

**NOTE:** It is recommended to use a network cable with a length between 7 and 230 feet. If the cable is too short, there may be no display output because the signal is too strong. If the cable is too long, the output may have poor quality.

## FAQ

- 1. There is no output on screen when all connections are correct?**
  - 1) Please make sure the HDMI cables supports 4Kx2K if the output signal from the source device is 4Kx2K resolution.
  - 2) Please check and make sure the network cable is inserted to the RJ45 port well.
  - 3) Restart the transmitter or receiver by pressing the reset button.
- 2. Black screen happened on the display/monitor?**
  - 1) Check if the length of the cable is within the specified range.
  - 2) Reset the transmitter to rebuild the connection.
  - 3) If you are connecting more receivers to the second receiver, please make sure the length does not exceed 165 feet between each receiver.
- 3. The display shows unusual color or no sound?**
  - 1) Reset the transmitter or receiver to rebuild the connection.
  - 2) Check if the HDMI cables are connected well.
  - 3) Reconnect the network cable.

## Hardware Installation

### Connection Diagram

### One to one

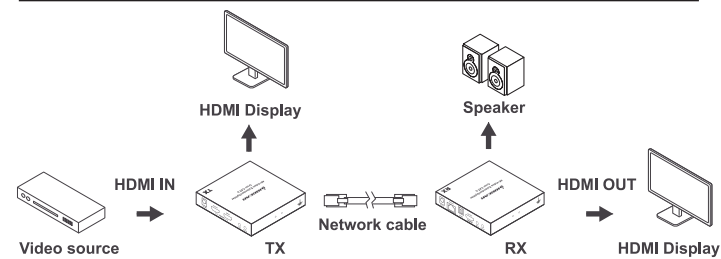

### One to many

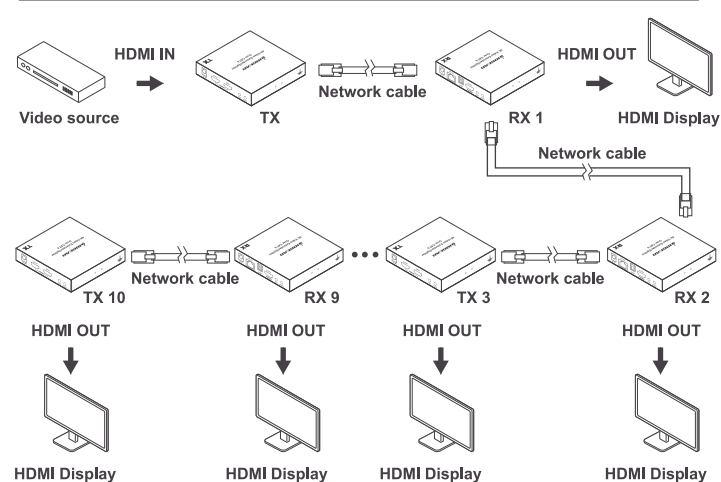

## Compliance Information

### Federal Communications Commission Interference Statement

This equipment has been tested and found to comply with the limits for a Class B digital device, pursuant to Part 15 of the FCC Rules. These limits are designed to provide reasonable protection against harmful interference when the equipment is operated in a commercial environment. This equipment generates, uses, and can radiate radio frequency energy and, if not installed and used in accordance with the instruction manual, may cause harmful interference to radio communications. Operation of this equipment in a residential area is likely to cause harmful interference in which case the user will be required to correct the interference at his own expense.

**FCC Caution:**

Any changes or modifications not expressly approved by the party responsible for compliance could void the user's authority to operate this equipment.

## Hardware Installation

## IR User Guide

- 1) IR blaster extension cable should plug in the IR OUT port off the transmitter, IR receiver extension cable should plug in the IR IN port of the receiver.
- 2) The emitter of the IR blaster extension cable should be as close as possible to the IR receiving window of the source device.
- 3) Face the receiving head of the IR receiver extension cable to the user for convenient remote control.

## Limited Warranty

This product carries a limited or lifetime manufacturer's warranty.  
For terms and conditions visit <https://www.iogear.com/support/warranty>

Register online at <https://www.iogear.com/register>

## Important Product Information

Product Model \_\_\_\_\_

Serial Number \_\_\_\_\_

## Contact Information

WE'RE HERE TO HELP YOU!  
NEED ASSISTANCE SETTING UP THIS PRODUCT?

Make sure you:

1. Visit [www.iogear.com](http://www.iogear.com) for more product information
2. Visit [www.iogear.com/support](http://www.iogear.com/support) for live help and product support

**IOGEAR**  
iogear.custhelp.com  
support@iogear.com  
www.iogear.com