

A solid green vertical rectangular bar located to the left of the title text.

# Quick Start Guide

## Expandable Wireless HDTV Connection Kit with 2 Receivers

---

**GWMRHDKIT**  
PART NO. Q1541

# Package Contents

1

- 1 x GWMRHDKIT Transmitter
- 2 x GWMRHDKIT Receiver
- 1 x Remote Control
- 3 x 3 Foot HDMI Cable
- 1 x IR Blaster Cable
- 2 x IR Receiver Extender Cable
- 3 x Antennas
- 3 x DC5V/2A Wall Mount Switching Power Supply
- 1 x Quick Start Guide
- 1 x Warranty Card

## Product Introduction

This HDMI wireless extender includes transmitter unit and 2 receiver units which allow the transmission and extension of HDMI signal up to 150 feet away wirelessly. It has strong interference rejection ability by running at 5GHz frequency. This wireless extender not only supports point to point configuration, but also supports one to many (1 to 2) and many to many (2 to 2, 2 to 1) configuration. This extender supports a wide range IR pass back frequency 20-60KHz to be able to control source devices from receiver side remotely. With both push-button control and IR controller this simplifies channel setting. This is a very good solution for transmitting one or more HDMI source signal to one or more screens for long distances without running wires, perfect for applications such as conference halls, home entertainment and education etc.

1. Smart portable design, great performance.
2. Highest resolution up to 1080p full HD.
3. Strong interference rejection ability by using 5GHz frequency with WPA encryption.
4. Supports point to point, point to multi point (1 to 2) and multi point to multi point (2 to 2, 2 to 1) configuration.
5. Supports IR pass-back with 20-60KHz frequency.
6. Supports push button control to set channels and IR controller to switch and choose input sources from receiver side (remotely).
7. 150 feet long range transmission.

## System Requirements

- 1 HDMI source device (DVD, PS3, Set top box, PC, etc.)
- 1 HDMI display device (SDTV, HDTV, projector with HDMI port, etc.)

## Transmitter Front

- A. Channel indicator
- B. Channel selector button
- C. IR remote control window

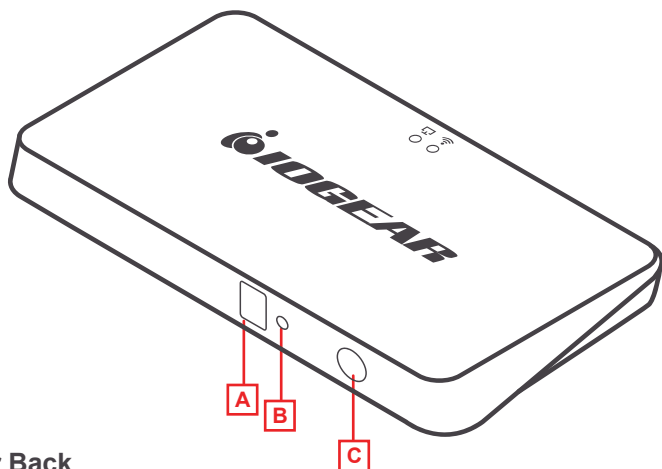

## Transmitter Back

- D. Power input
- E. HDMI input
- F. HDMI input signal indicator
- G. Wireless signal indicator
- H. IR blaster cable connector
- I. Antenna connector

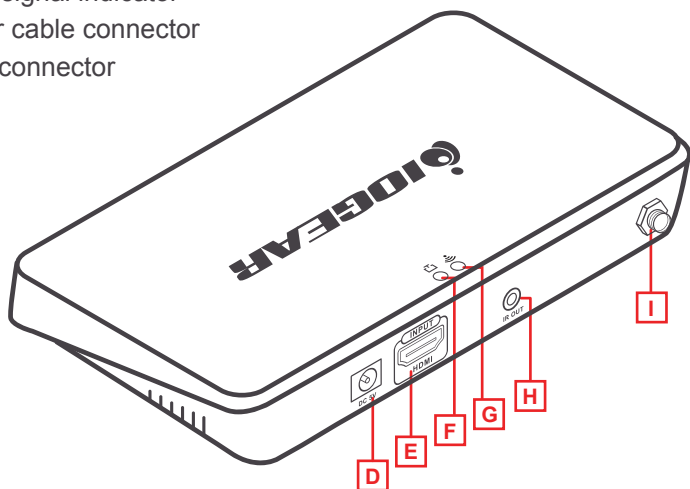

## Receiver Front

- A. Input Channel indicator
- B. Channel selector button
- C. IR remote control window

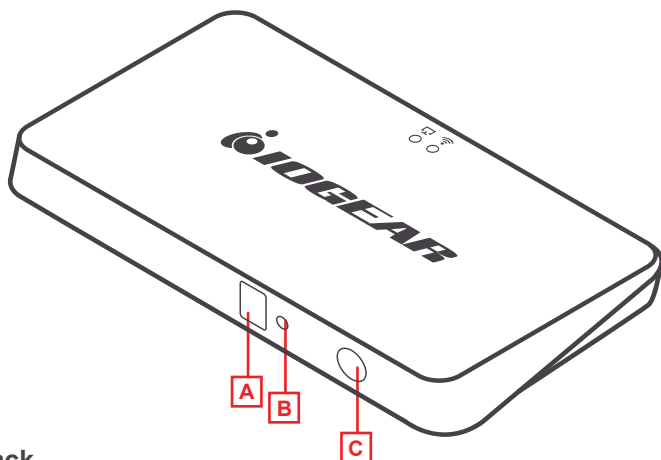

## Receiver Back

- D. Power input
- E. Data transmission indicator
- F. Wireless connection indicator
- G. HDMI output connector
- H. IR receiver extender cable connector
- I. Antenna connector

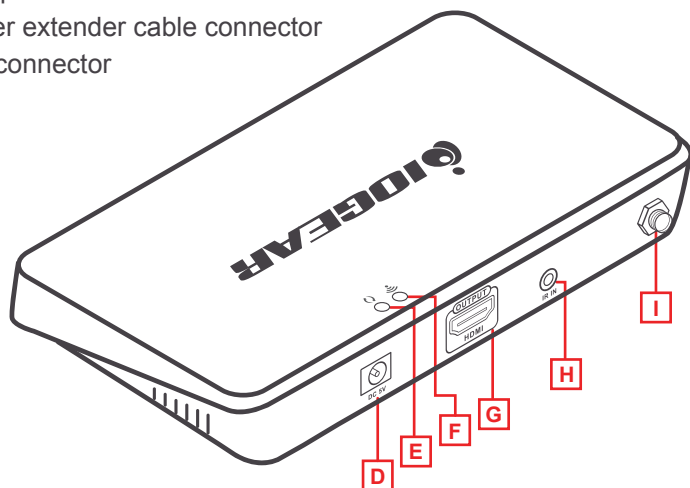

Please read safety instructions carefully before installation and operation:

1. Please pay attention to all the warnings and hints for this device.
2. Do not expose this unit to rain, moisture or liquid.
3. Do not insert any foreign object into the device.
4. Opening the enclosure will void the warranty.
5. Place the device in a well ventilated area.
6. Use DC5V/2A power adapter only. Make sure the specification matched if using 3rd party DC adapters.

Note:

- 1) Transmission distance will vary due to the environment.
- 2) Obstructions such as wall, brick or glass will shorten the signal cover range or cause signal degradation.
- 3) It is recommended that the distance between each unit should be more than 15 feet.

## Connection Options

1 Transmitter .....➤ 1 Receiver

1 Transmitter .....➤ 2 Receivers

2 Transmitters .....➤ 1 Receiver

2 Transmitters .....➤ 2 Receivers

## Transmitter

- STEP 1 Install the antenna to the transmitter
- STEP 2 Connect the IR blaster cable to the connector
- STEP 3 Connect one side of the HDMI cable to the transmitter and the other side to your video source
- STEP 4 Connect DC5V/2A power adapter to the Transmitter power input port

When connected to the source and powered up you will have 2 Solid LEDS

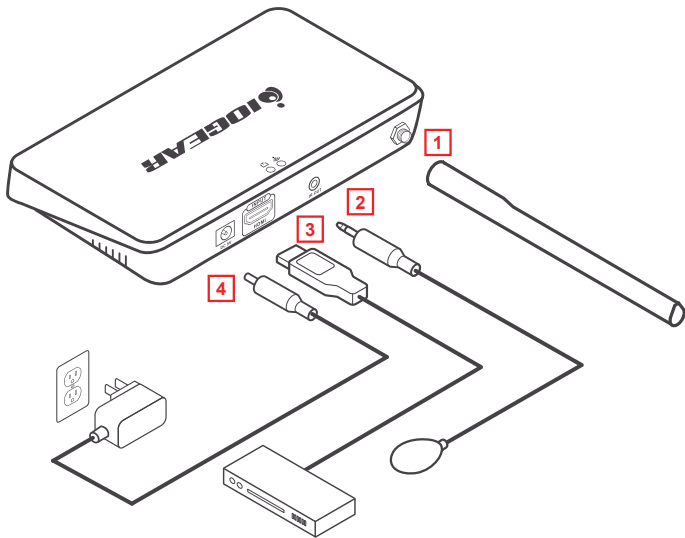

## Receiver

- STEP 5 Install the antenna to the receiver
- STEP 6 Connect the IR receiver extender cable to the connector
- STEP 7 Connect one side of the HDMI cable to the receiver and the other side to your HDMI display device
- STEP 8 Connect DC5V/2A power adapter to the Receiver power input port

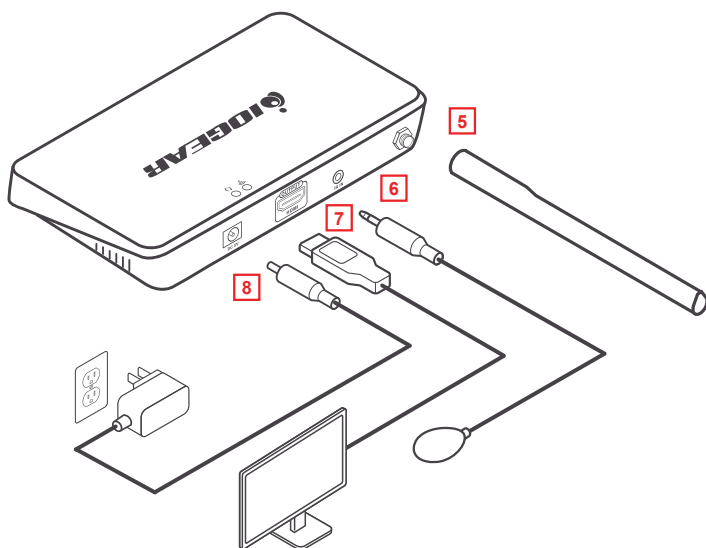

When the Receiver is connected, the TV will display - wait for connection to be established.

Once connected to the transmitter, the LEDs will have 1 solid and 1 flashing.

## STEP 9

Please select channel on your receiver(s) to match the channel on your transmitter to stream content of the video source that the transmitter is connected to

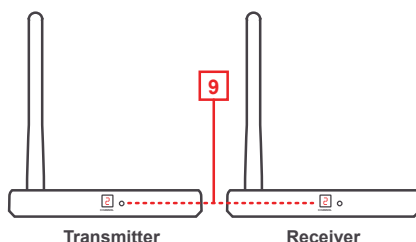

Channel selection can be done in 2 ways, manually press the button in front of the transmitter and the receiver or you can use the included remote to select the channels. To use the remote, simply point the included remote to the front of each unit after making sure that you have removed the plastic tab at the battery cover to enable the battery connection.

## Note:

The wireless connection is established when you have one solid and one flashing LED on both the transmitter and receiver. If your video source and your display is on, you should be able to see the content of the source on your display.



Items		Specification
Power supply	Voltage/Current	DC5V/2A
	Power consumption	TX < 7W   Rx < 5W
HDMI performance and interface	HDMI compliance	HDMI 1.3
	HDCP compliance	HDCP 1.2
	HDMI resolution supported	480i@60Hz, 480p@60Hz, 576i@50Hz, 576p@50Hz, 720p@50/60Hz, 1080i@50/60Hz, 1080p@50/60Hz
	Supports audio formats	PCM
	Maximum transfer rate	10.2Gbps
	Input and output TMDs signal	0.5 ~ 1.5Vp-p (TMDS)
	Input and output DDC signal	5Vp-p (TTL)
	Input cable length supported	≤ 5m (AWG26 HDMI 1.3 cable standard)
	Output cable length supported	≤ 5m (AWG26 HDMI 1.3 cable standard)
IR performance and interface	IR remote control	Support IR passback with 20-60KHz frequency
Wireless performance and interface	Transmission method	5.8G Wireless transmission
	Transmission distance	50 Meters (164 Feet)
	Latency	≤ 200 ms
Protection level	Electrostatic protection of the whole machine	1a Contact discharge level 3
		1b Air discharge level 3
		Standard EC61000-4-2
Operating environment	Working temperature	0 ~ 50°C (32 ~ 122°F)
	Storage temperature	-10 ~ 70°C (14 ~ 158°F)
	Humidity (no condensation)	0 ~ 90%
Body properties	Dimension	3.7 (W) x 4.75 (D) x .79 (H) in
	Material	Plastic
	Processing technology	Sandblasting
	Colour	Black
	Weight	TX: 200g (.44lb), RX: 200g (.44lb)
Reliability	Mean time between failures (MTBF)	>30000 Hours

# Compliance Information

## Federal Communication Commission Interference Statement

This equipment has been tested and found to comply with the limits for a Class B digital service, pursuant to Part 15 of the FCC rules. These limits are designed to provide reasonable protection against harmful interference in a residential installation. Any changes or modifications made to this equipment may void the user's authority to operate this equipment. This equipment generates, uses, and can radiate radio frequency energy. If not installed and used in accordance with the instructions, may cause harmful interference to radio communications. However, there is no guarantee that interference will not occur in a particular installation. If this equipment does cause harmful interference to radio or television reception, which can be determined by turning the equipment off and on, the user is encouraged to try to correct the interference by one or more of the following measures:

- Reorient or relocate the receiving antenna
- Increase the separation between the equipment and receiver
- Connect the equipment into an outlet on a circuit different from that to which the receiver is connected
- Consult the dealer or an experienced radio/TV technician for help

**FCC Caution:** Any changes or modifications not expressly approved by the party responsible for compliance could void the user's authority to operate this equipment.

## Limited Warranty

This product carries a 1 Year Limited Warranty. For the terms and conditions of this warranty, please go to <https://www.iogear.com/support/warranty>

Register online at <https://www.iogear.com/register>

Important Product Information

Product Model \_\_\_\_\_

Serial Number \_\_\_\_\_

WE'RE HERE TO HELP YOU!  
NEED ASSISTANCE SETTING UP THIS PRODUCT?

Make sure you:

1. Visit [www.iogear.com](http://www.iogear.com) for more product information
2. Visit [www.iogear.com/support](https://www.iogear.com/support) for live help and product support

**IOGEAR**

<https://iogear.custhelp.com>

[support@iogear.com](mailto:support@iogear.com)

[www.iogear.com](http://www.iogear.com)