

A solid green vertical bar is positioned on the left side of the page, spanning the height of the main title section.

# Quick Start Guide

## Ultra Long Range Wireless 4K @ 60 Hz Video Extender Kit

---

**GWLR4K60KIT**

PART NO. Q1560

## Package Contents

1

- 1 x HDMI Extender Transmitter
- 1 x HDMI Extender Receiver
- 1 x IR Blaster Cable
- 1 x IR Receiver Cable
- 2 x 5 VDC/2A Switching Power Supply
- 1 x Quick Start Guide
- 1 x Warranty Card

## System Requirements

- 1 HDMI source device (Bluray, Satellite box, PC etc.)
- 1 HDMI display device (HDTV, projector with HDMI port, etc.)

## Transmitter Front

- A. Power indicator
- B. Wireless indicator
- C. Source indicator

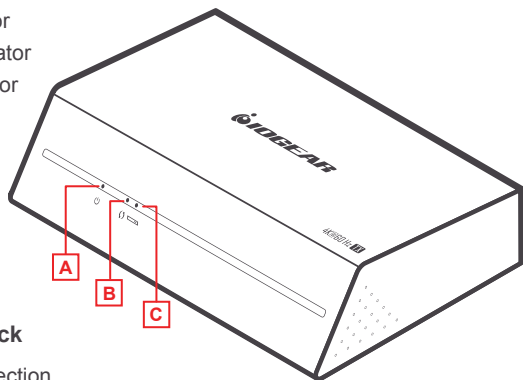

## Transmitter Back

- D. Antenna connection
- E. Power input
- F. HDMI input connector
- G. IR output connector
- H. Reset button

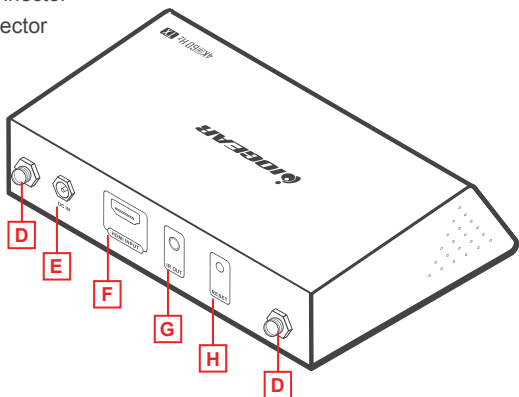

## Receiver Front

- A. Power indicator
- B. Wireless indicator
- C. Display indicator

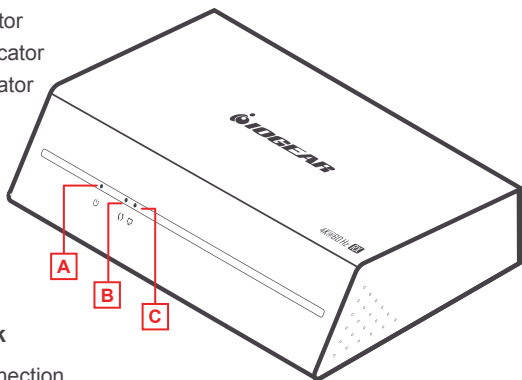

## Receiver Back

- D. Antenna connection
- E. Power input
- F. HDMI output connector
- G. IR input connector
- H. Reset button

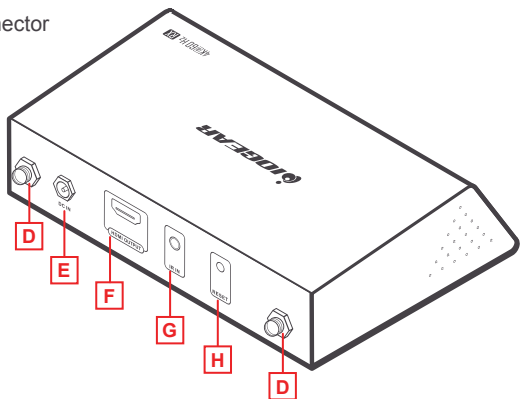

## Hardware Installation

## STEP 1

### Install the antenna to the transmitter

## STEP 2

(Optional) Connect the IR blaster cable to the connector

### STEP 3

Connect one side of the HDMI cable to the transmitter HDMI input port and the other side to your video source

### STEP 4

### Install the antennas to the receiver

## STEP 5

(Optional) Connect the IR extender cable to the connector

## STEP 6

Connect one side of the HDMI cable to the receiver and the other side to your video source

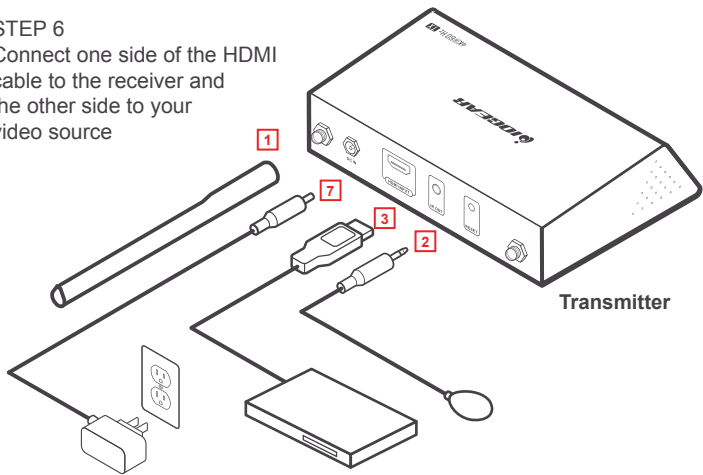

## STEP 7

Connect 5VDC/2A power supply to the Transmitter power input port, the HDMI signal indicator will light up when connection to the source is established

## STEP 8

Connect 5VDC/2A power supply to the Receiver power input port

STEP 9 Wireless connection indicator of the transmitter and receiver will light up when the transmitter and receiver are connection is established wirelessly

If your video source and your display is on, you should be able to see the content of the source on your display

**\* For optimal performance, a line of sight is recommended**

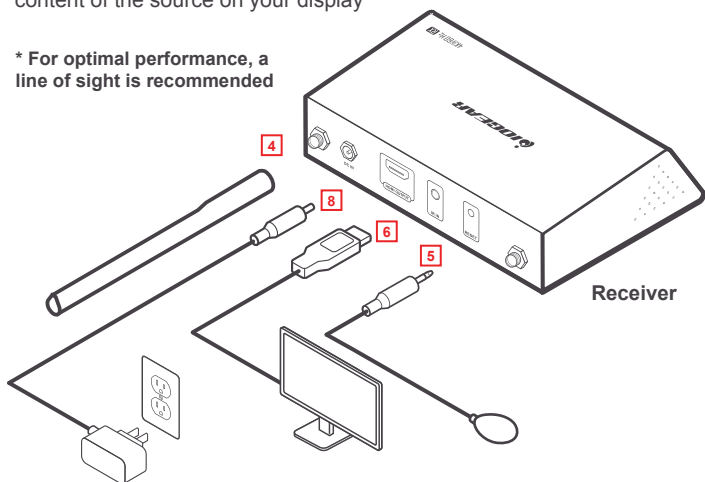

**NOTE:** Distances may vary depending on environment. Solid and non-porous materials such as steel, concrete, brick and glass (varies depending on coating and thickness) may cause shorter viewing distances or loss of signal.

**Q Transmitter and receiver will not connect wirelessly**

- A**
1. Please check if the wireless connection light is on and blinking
  2. Restart the transmitter and then the receiver by pressing the reset button on the back of the unit in that order
  3. Reconnect HDMI cables

For optimal performance, a line of sight is recommended

**Q The wireless indicator is on but nothing on the display**

- A**
- Please check and see if the video source is working correctly by connecting the HDMI cable directly to the display and see if the operation is now normal

**Q Video is flickering or not stable**

- A**
1. Change the position of the transmitter and receiver and make sure that they are within the specified operating distance
  2. Restart the transmitter and receiver
  3. Reconnect the HDMI cables
  4. Check for any obstacles that may block the wireless signal from the transmitter to the receiver

**Q Can you add more receivers to 1 transmitter?**

- A** Yes the part number is GWLR4K60RX

**Q How many receivers can you add and how will this affect the performance?**

- A**
- 1 Transmitter to 1 receiver – Up to 600 feet with a direct line of site
  - 1 Transmitter to 2 receivers – Up to 200 feet with a direct line of site
  - 1 Transmitter to 3 receivers – Up to 100 feet with a direct line of site

## Compliance Information

**⚠ WARNING:** This product can expose you to chemicals including styrene which is known to the State of California to cause cancer and birth defects or other reproductive harm. For more information, go to [www.P65Warnings.ca.gov](http://www.P65Warnings.ca.gov)

### FCC Statement

This equipment has been tested and found to comply with the limits for a Class B digital device, pursuant to Part 15 of the FCC Rules. These limits are designed to provide reasonable protection against harmful interference in a residential setting. This product generates, uses, and can radiate radio frequency energy and, if not installed and used as directed, it may cause harmful interference to radio communications. Although this product complies with the limits for a Class B digital device, there is no guarantee that interference will not occur in a particular installation.

### CE Statement

This device has been tested and found to comply with the following European Union directives: Electromagnetic Capability (2004/108/EC), Low Voltage (2006/95/EC) and R&TTED (1999/5/EC).

## Limited Warranty

This product carries a 1 Year Limited Warranty. For the terms and conditions of this warranty, please go to <https://www.iogear.com/support/warranty>

Register online at <https://www.iogear.com/register>

Important Product Information

Product Model \_\_\_\_\_

Serial Number \_\_\_\_\_

## Contact

WE'RE HERE TO HELP YOU!  
NEED ASSISTANCE SETTING UP THIS PRODUCT?

Make sure you:

1. Visit [www.iogear.com](http://www.iogear.com) for more product information
2. Visit [www.iogear.com/support](http://www.iogear.com/support) for live help and product support

**IOGEAR**

<https://iogear.custhelp.com>

[support@iogear.com](mailto:support@iogear.com)

[www.iogear.com](http://www.iogear.com)