



Quick Start Guide

Wireless TV Connection Kit

GWHDBBKIT

PART NO. Q1543

Package Contents

1

- 1 x HDMI Extender Transmitter
- 1 x HDMI Extender Receiver
- 1 x IR Blaster Extension Cable
- 1 x IR Receiver Extension Cable
- 2 x 5 VDC/2A Wall Mount Switching Power Supply
- 1 x Quick Start Guide
- 1 x Warranty Card

System Requirements

- 1 HDMI source device (DVD, PS3, Set top box, PC etc.)
- 1 HDMI display device (SDTV, HDTV, projector with HDMI port, etc.)

Transmitter

- A. Power input
- B. HDMI input
- C. HDMI signal indicator
- D. Wireless signal indicator
- E. IR Blaster extension cable connector
- F. Antenna connector

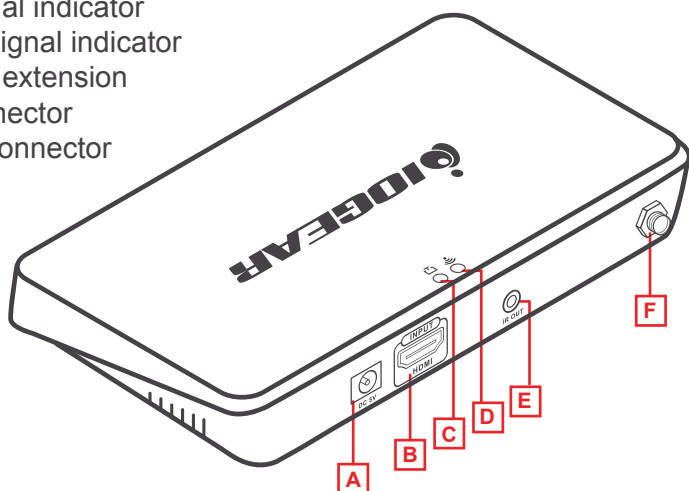

Receiver

- G. Power input
- H. Data transmission indicator
- I. Wireless connection indicator
- J. HDMI output connector
- K. IR receiver extension cable connector
- L. Antenna connector

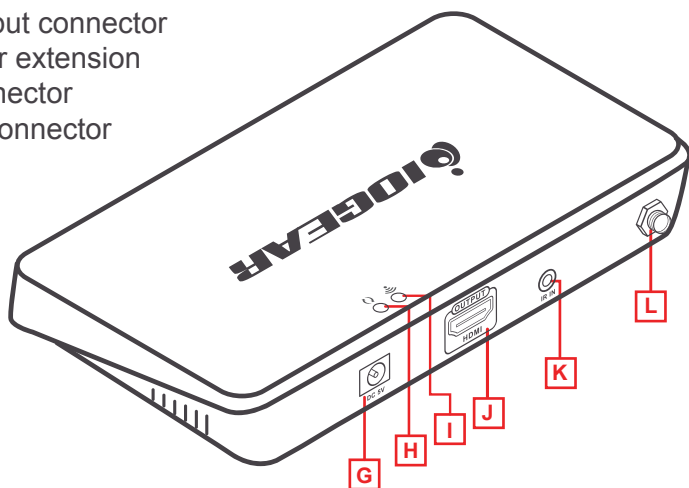

Transmitter (Transmitter needs to be connected first and powered up and both lights blinking)

STEP 1

Install the antenna to the transmitter (F)

STEP 2

Connect the IR blaster cable to the connector (E)

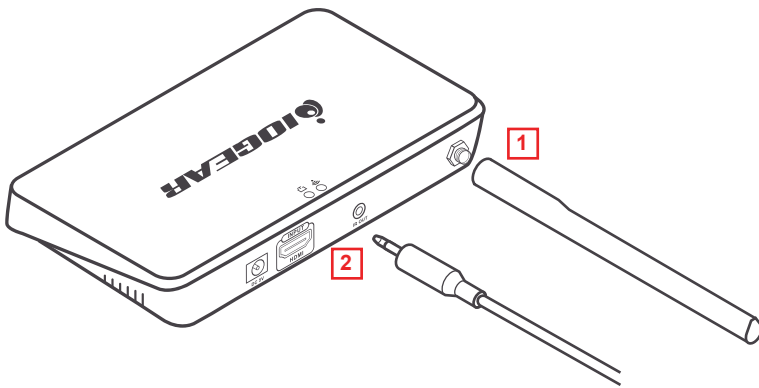

STEP 3

Connect one side of the HDMI cable to the transmitter (D) and the other side to your video source

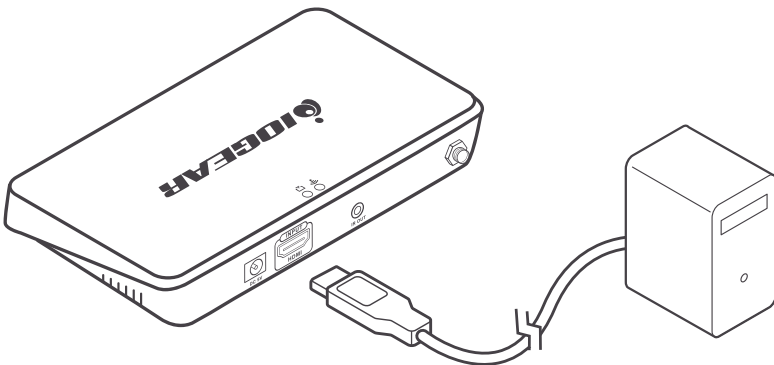

Receiver

STEP 4

Install the antenna to the receiver (L)

STEP 5

Connect the extension cable to the connector (E)

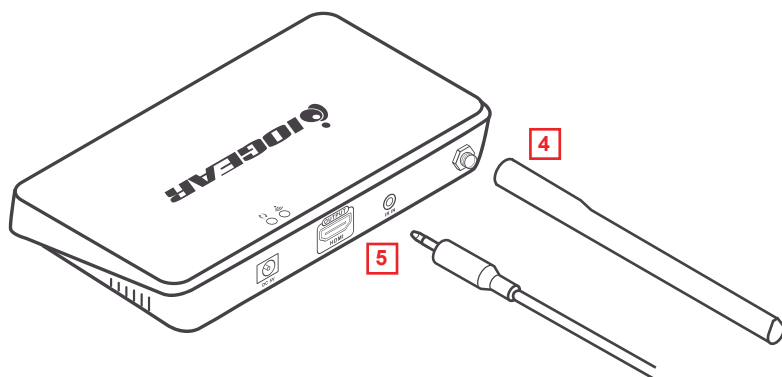

STEP 6

Connect one side of the HDMI cable to the receiver (J) and the other side to your video source

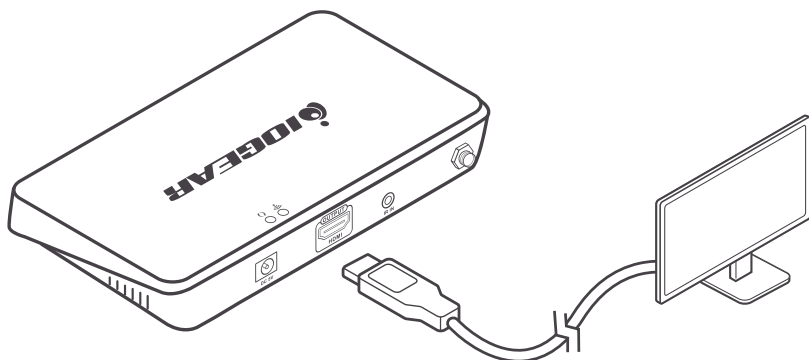

STEP 7

Connect 5VDC/2A power supply to the Transmitter power input port (A), the HDMI signal indicator (C) will light up when connection to the source is established

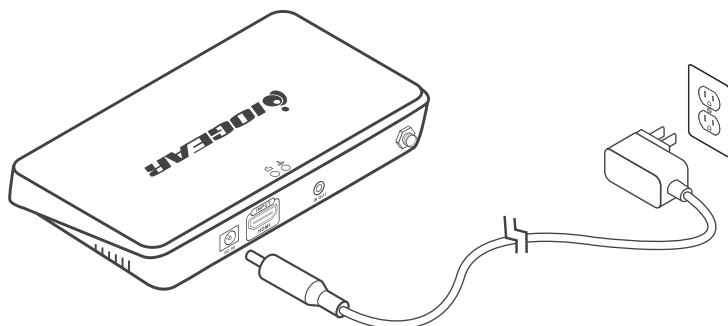

STEP 8

Connect 5VDC/2A power supply to the Receiver power input port (G)

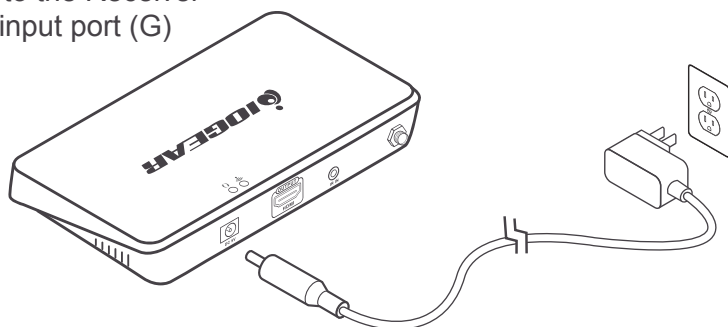

STEP 9

Wireless connection indicator of the transmitter and receiver will light up when the transmitter and receiver connection is established wirelessly

If your video source and your display is on, you should be able to see the content of the source on your display

NOTE: *Distances may vary depending on environment. Solid and non-porous materials such as steel, concrete, brick and glass (varies depending on coating and thickness) may cause shorter viewing distances or loss of signal.

FAQ

Q Transmitter and receiver cannot be connected wirelessly

- A
1. Please check if the wireless connection light is on and blinking
 2. Restart both transmitter and receiver
 3. Reconnect HDMI cables

Q The wireless indicator is on but no signal to the display

- A
- Please check and see if the video source is working correctly by connecting the HDMI cable directly to the display and see if the operation is now normal

Q Video is flickering or not stable

- A
1. Change the position of the transmitter and receiver and make sure that they are within the specified operating distance
 2. Restart the transmitter and receiver
 3. Reconnect the HDMI cables
 4. Check for any obstacles that may block the wireless signal from the transmitter to the receiver

Compliance Information

 **WARNING:** This product may expose you to chemicals including styrene which is known to the State of California to cause cancer, birth defects or other reproductive harm. For more information, go to www.P65Warnings.ca.gov

Federal Communication Commission Interference Statement

This equipment has been tested and found to comply with the limits for a Class B digital service, pursuant to Part 15 of the FCC rules. These limits are designed to provide reasonable protection against harmful interference in a residential installation. Any changes or modifications made to this equipment may void the user's authority to operate this equipment. This equipment generates, uses, and can radiate radio frequency energy. If not installed and used in accordance with the instructions, may cause harmful interference to radio communications. However, there is no guarantee that interference will not occur in a particular installation. If this equipment does cause harmful interference to radio or television reception, which can be determined by turning the equipment off and on, the user is encouraged to try to correct the interference by one or more of the following measures:

- Reorient or relocate the receiving antenna
- Increase the separation between the equipment and receiver
- Connect the equipment into an outlet on a circuit different from that to which the receiver is connected
- Consult the dealer or an experienced radio/TV technician for help

FCC Caution: Any changes or modifications not expressly approved by the party responsible for compliance could void the user's authority to operate this equipment.

Limited Warranty

This product carries a 1 Year Limited Warranty. For the terms and conditions of this warranty, please go to <https://www.iogear.com/support/warranty>

Register online at <https://www.iogear.com/register>

Important Product Information

Product Model _____

Serial Number _____

Contact

WE'RE HERE TO HELP YOU!
NEED ASSISTANCE SETTING UP THIS PRODUCT?

Make sure you:

1. Visit www.iogear.com for more product information
2. Visit www.iogear.com/support for live help and product support

IOGEAR

<https://iogear.custhelp.com>

support@iogear.com

www.iogear.com