



# Quick Start Guide

2.4 GHz Multimedia Keyboard  
with Optical Trackball and Scroll Wheel

---

GKM561R

PART NO. Q1096-a

[www.iogear.com](http://www.iogear.com)

## Keyboard – Front View

1. Mouse Left Click
2. Mouse Right Click
3. Battery low Indicator
4. Scroll Wheel
5. Last Track
6. Next Track
7. Play / Pause
8. Stop
9. Mute
10. Volume Up
11. Volume Down
12. Default Homepage (Internet Explorer)
13. Removable Optical Trackball



## Keyboard – Back View

1. ON/OFF Switch
2. Reset Button
3. Battery Cover

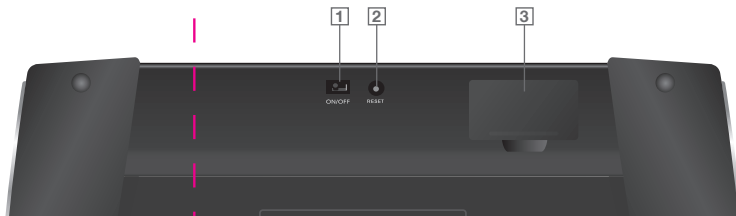

## USB RF Receiver

1. USB Connection



- 1 x GKM561R 2.4GHz Multimedia Keyboard
- 1 x USB RF Receiver
- 1 x Cleaning Cloth
- 2 x AA Batteries
- 1 x Quick Start Guide
- 1 x Warranty Card

## Requirements

### **Computer / Devices\***

- USB port

### **Operating System\*\***

- Windows Vista®
- Windows® 7
- Windows® 8
- Windows® 8.1
- Mac OS X v10.3.9 or later\*\*\*

\*Device must support USB HID keyboard device and USB HID-compliant mouse in order to have the keyboard and mouse functionality respectively.

\*\*Media Center hotkeys are only supported with operating systems that have Microsoft Windows Media Center.

\*\*\*Some Mac special keys may not work.

## STEP 1

Connect the USB RF receiver into any open USB port of your computer while the computer is turned on.



## STEP 2

Open the battery cover on the back of the keyboard and insert the 2 included AA batteries into the battery tray.\* Then, close the battery tray by putting the battery cover back on.



\*Note: Please make sure the batteries are installed properly as the directions that are indicated inside the battery tray

## STEP 3

Turn on the keyboard by switching the **ON/OFF** switch to the **ON** position.

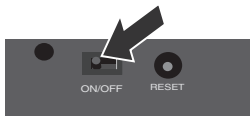

## FINAL STEP

Now the keyboard and trackball should be working properly. If the keyboard and trackball are not working, please see the **Pairing Section**.

## Pairing (Optional)

4

### STEP 1

Press the Reset button on the back of the keyboard next to the **ON/OFF** switch while the keyboard is in **ON** position.



### STEP 2

Un-plug and reconnect the USB RF Receiver into any open USB port of your computer while the computer is turned on.



\*If you have multiples of the same keyboard in the same area, please make sure you press the **Reset** button when the keyboard is the closest to the specific USB RF Receiver that you want to connect to. The keyboard will connect to the closest USB RF receiver within range.

### FINAL STEP

You will then see the **Battery Low LED** light up, when it goes off, the pairing is completed. Now the keyboard and trackball should be working properly. If the keyboard and trackball are not working, please repeat the steps in **Pairing Section**.

When the keyboard is idle for 30 minutes, it will go into sleep mode for battery saving purposes. Simply press any key to wake the keyboard up and resume usage.

## Function Keys

There are 19 sets of function keys on this keyboard. To invoke these functions, hold the function button (Fn) then press the function key (the keys with blue letters).

### Normal Function Keys

| Function  | Description |
|-----------|-------------|
| Home      | Fn + Home   |
| End       | Fn + End    |
| Insert    | Fn + Ins    |
| Page Up   | Fn + PgUp   |
| Page Down | Fn + PgDn   |

### Changing Optical Trackball's DPI

| Function                                 | Description  |
|--|--------------|
| Change trackball's resolution to 500DPI  | Fn + 500DPI  |
| Change trackball's resolution to 1000DPI | Fn + 1000DPI |
| Change trackball's resolution to 1500DPI | Fn + 1500DPI |

## Media Center Shortcut Keys

| Function                            | Description      |
|-------------------------------------|------------------|
| Launch Windows Media Center         | Fn + MCE         |
| Launch My TV                        | Fn + My TV       |
| Launch My Videos                    | Fn + My Videos   |
| Launch My Music                     | Fn + My Music    |
| Launch My Pictures                  | Fn + My Pictures |
| Record TV                           | Fn + Record TV   |
| Play DVD (within Media Center only) | Fn + DVD         |
| Rewind                              | Fn + ◀◀          |
| Fast Forward                        | Fn + ▶▶          |
| Channel Up                          | Fn + Ch+         |
| Channel Down                        | Fn + Ch-         |

## Removing the Optical Trackball

7

### STEP 1

Start by Powering Off the keyboard by switching the **ON/OFF** switch to the **OFF** position.

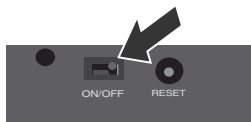

### STEP 2

Unlock the trackball cover by twisting **COUNTERCLOCKWISE** until the raised dot indicators are aligned. Lift up the trackball cover to remove it.

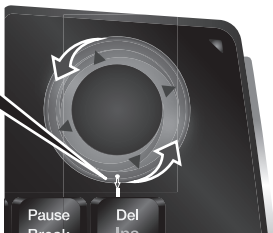
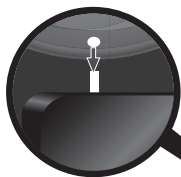
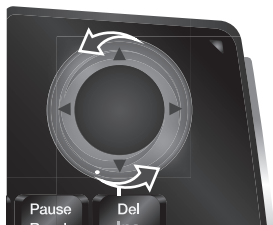



### STEP 1

Put the trackball inside the trackball assembly. Place the trackball cover over the trackball by aligning the raised indicators.

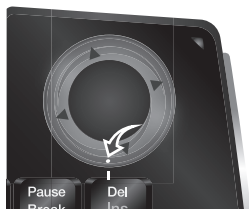

### STEP 2

Lock the trackball cover into place by twisting **CLOCKWISE** until down arrow is aligned with the raised indicator.

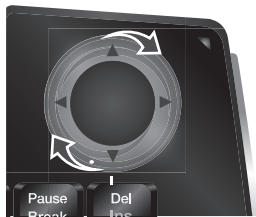

## Compliance Information

### **FCC Statement**

This equipment has been tested and found to comply with the limits for a Class B digital device, pursuant to Part 15 of the FCC Rules. These limits are designed to provide reasonable protection against harmful interference in a residential setting. This product generates, uses, and can radiate radio frequency energy and, if not installed and used as directed, it may cause harmful interference to radio communications. Although this product complies with the limits for a Class B digital device, there is no guarantee that interference will not occur in a particular installation.

### **CE Compliance**

This device has been tested and found to comply with the following European Union directives: Electromagnetic Capability (2004/108/EC), Low Voltage (2006/95/EC) and R&TTED (1999/5/EC).

## Limited Warranty

### **WE'RE HERE TO HELP YOU! NEED ASSISTANCE SETTING UP THIS PRODUCT?**

Make sure you:

1. Visit [www.iogear.com](http://www.iogear.com) for more product information
2. Visit [www.iogear.com/support](http://www.iogear.com/support) for live help and product support

### **Warranty Information**

This product carries a 3 Year Limited Warranty. For the terms and conditions of this warranty, please go to [http://www-iogear.com/support/warranty](http://www.iogear.com/support/warranty)

Register online at <http://www.iogear.com/register>

Important Product Information

Product Model \_\_\_\_\_

Serial Number \_\_\_\_\_

## Contact

[iogear.custhelp.com](http://iogear.custhelp.com)

[support@iogear.com](mailto:support@iogear.com)

[www.iogear.com](http://www.iogear.com)

19641 Da Vinci, Foothill Ranch, CA 92610