

Federal Communications Commission (FCC) Statement

This product has been tested and found to comply with the limits for a Class B device, pursuant to part 15 of the FCC Rules. It is intended for use in residential setting, but may also be used in commercial or industrial setting.

CE Compliance

This device has been tested and found to comply with the following European Union directives: Electromagnetic Capability (2004/108/EC), Low Voltage (2006/95/EC) and R&TTED (1999/5/EC).

Limited Warranty

WE'RE HERE TO HELP YOU! NEED ASSISTANCE SETTING UP THIS PRODUCT?

- Make sure you:
1. Visit www.iogear.com for more product information
 2. Visit www.iogear.com/support for live help and product support

Warranty Information
This product carries a 1 Year Limited Warranty. For the terms and conditions of this warranty, please go to <http://www.iogear.com/support/warranty>

Register online at <http://www.iogear.com/register>

Important Product Information

Product Model _____
Serial Number _____

Contact

Toll Free 866-9-IOGEAR (USA) 19641 Da Vinci, www.iogear.com
Phone: 949-453-8782 Foothill Ranch, CA 92610 support@iogear.com

About Us

- FUN**
IOGEAR offers connectivity solutions that are innovative, fun, and stylish, helping people enjoy daily life using our high technology products.
- GREEN**
IOGEAR is an environmentally conscious company that emphasizes the importance of conserving natural resources. The use of our technology solutions helps reduce electronic waste.



Quick Start Guide 3D Complete +

Package Contents

- | | |
|---|-----------------------|
| 1 x 3D Complete + Unit | 1 x Quick Start Guide |
| 1 x Power Adapter | 1 x Warranty card |
| 1 x Remote Control
(with CR2025 battery pre-installed) | |

Requirements

- HDMI Source
- 3D-Ready TV or Projector
- Active or Passive 3D Glasses

Specification

Item	Description
I/O	LED: Green x4
	HDMI A Type Female Connector x5
	Power Jack x1
Power	Input: AC 100-240V
	Output: DC 5V/2.5A
Housing	Plastic
Audio	HDMI output embedded
Dimensions (LxWxH)	150 x100 x 22 mm
Operation Temperature	0°C~40°C
Storage Temperature	-10°C~70°C
Compliance	FCC

Product Overview

3D Complete +

1. **Remote sensor:** Receives the remote control signals.
2. **Source indicators:** Lights up when source is inputted.
3. **Source button:** Switches between different input sources.
4. **Power button:** Turn the power to on or off.
5. **DC IN:** Plugs the supplied power adapter.
6. **HDMI output:** Outputs the image source to a HDMI display device.
7. **HDMI inputs:** Inputs image sources.

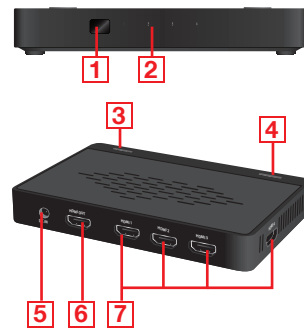

Remote Control

1. **Power button:** Press to turn the power to on or off.
2. **2D Button:** To enable 2D mode and enable/disable video enhancement function
3. **3D button:** Enable the 3D function.
4. **1/2/3/4 Source buttons:** Select the desired input source by pressing the number button.
5. **Adjust buttons:** Press to adjust the level of 3D LEVEL, DEPTH or POP.

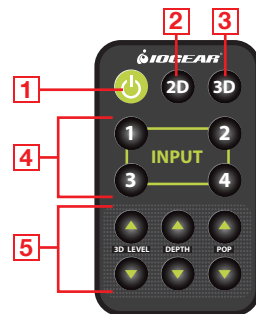

Remote Control

Using remote control for the first time
Pull out the insulating film from the remote control if the remote control is being used for the first time.



Remote Control

Replacing the battery inside of the remote control

Replace the battery when the battery is low power.

1. Push and hold the release tab to the right, and then pull out the battery holder.

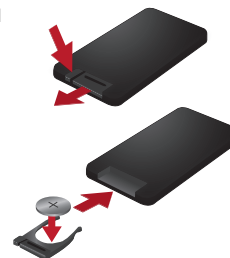

2. Replace the battery with CR2025 (3V lithium battery) by following the orientation which printed on the battery holder.

3. Push the holder back to the remote control.

Caution

- Be careful of your fingernails when pushing the battery release tab.
- Dispose the old battery in accordance with local regulations.
- Make sure the battery's orientation is correct. Improper or incorrect replacement of battery may cause fire, personal injury or damage to property.
- Keep the cell battery (CR2025) away from children. Consult a medical advice immediately if a child swallows the battery.

Installation

Connect the power adapter

Plug the DC connector plug of power adapter into the 3D Complete+ unit, and the other end of adapter into a wall outlet.

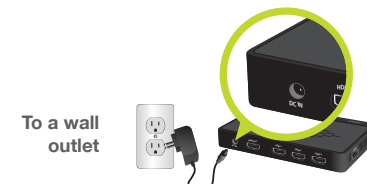

Input a source to the 3D Complete+ unit

The source shown below is an example only. The source must be a device which supported HDMI output, such as a BD player, DVD player, Set-Top box, camcorder and so on. Plug one end of HDMI cable into HDMI input connector of the 3D Complete+ unit, and the other end of HDMI cable into the HDMI output of source. Four HDMI inputs are supported by this 3D Complete+ unit.

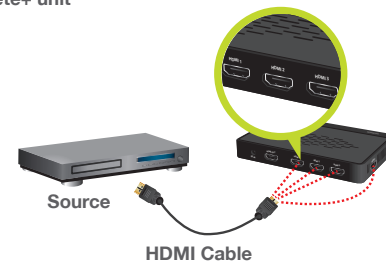

Remote Control

Connect the 3D Complete+ unit to a TV

Plug one end of HDMI cable into HDMI output connector of the 3D Complete+ unit, and the other end of HDMI cable into a HDMI input connector of a 3D-Ready TV or projector.

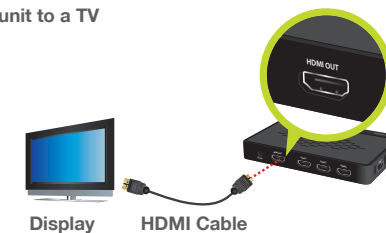

Operation

1. Follow the Connection section to connect the 3D Complete+ unit , and then press **Power** button on the remote control to turn on the 3D Complete+ unit. Alternatively, press **Power** button on the top panel of 3D Complete+ unit to turn the power to on.
2. Press the Source button on the top panel to select an available or desired input source if the screen shows **No input signal**.



Image Enhancement

1. Press **2D** button to enhance the images of source. Verify at the lower right of the screen that **Video Enhancement On** is displayed
2. To see the difference between the original source and enhanced image, press the **Depth Up Arrow** or **Down Arrow** keys to split the screen.
3. To turn off the image enhancement, press **2D** button again.



Note: Sometimes the TV's screen may display a black screen when inputting source from a computer. This indicates the resolution set on the computer is not supported by the TV. Specify a resolution and refresh rate that the TV can recognize or select the display mode to "Extended" on the computer. For more supported resolutions, refer to the TV's instruction manual.

2D to 3D

1. Press **3D** button to enable the 3D function.
2. Pressing the **3D** will enable the 3D function but not disable it. The **2D** disables the 3D function.

Note: The 3D function is available on the display device which supports 3D display and the refresh rate is 120MHz at least.



Configuration

1. To configure the **3D LEVEL**, **DEPTH** or **POP**, press **▲** or **▼** button corresponding to the item of the remote control.
2. The  (adjustment bar) will appear on the lower left of the screen. Press **▲** to increase or press **▼** to decrease the level.

Note: The adjustments of **3D LEVEL**, **DEPTH** and **POP** are available only in the 3D mode.

3D Level

3D Level allows you to fine tune the optimal balance of presets between 3D Pop and Depth effects. Using the 3D Level **▲** and **▼** button on the remote control, adjust the bar level to the right to increase the amount of preset 3D Depth and reduce the amount of preset 3D Pop. Adjust the bar level to the left to decrease the amount of preset 3D Depth and increase the amount of preset 3D Pop.

3D Depth

3D Depth adjusts the amount of depth going into your 3D TV. Using the 3D Depth **▲** and **▼** keys on the remote control, adjust the bar level to the right to increase the amount of depth effect and adjust the bar level to the left to decrease.

3D Pop

3D Pop controls the amount of the video images popping out of your 3D TV. Using the 3D Pop **▲** and **▼** button on the remote control, adjust the bar level to the right to increase the amount that images pop out at you and adjust the bar level to the left to decrease.