

1. Please install the software "FuhlenBind\_EnglishV1.3.exe"
2. Please open the installed software and you will get below interface  
plug the receiver into your PC USB port, and click "PAIRING" here

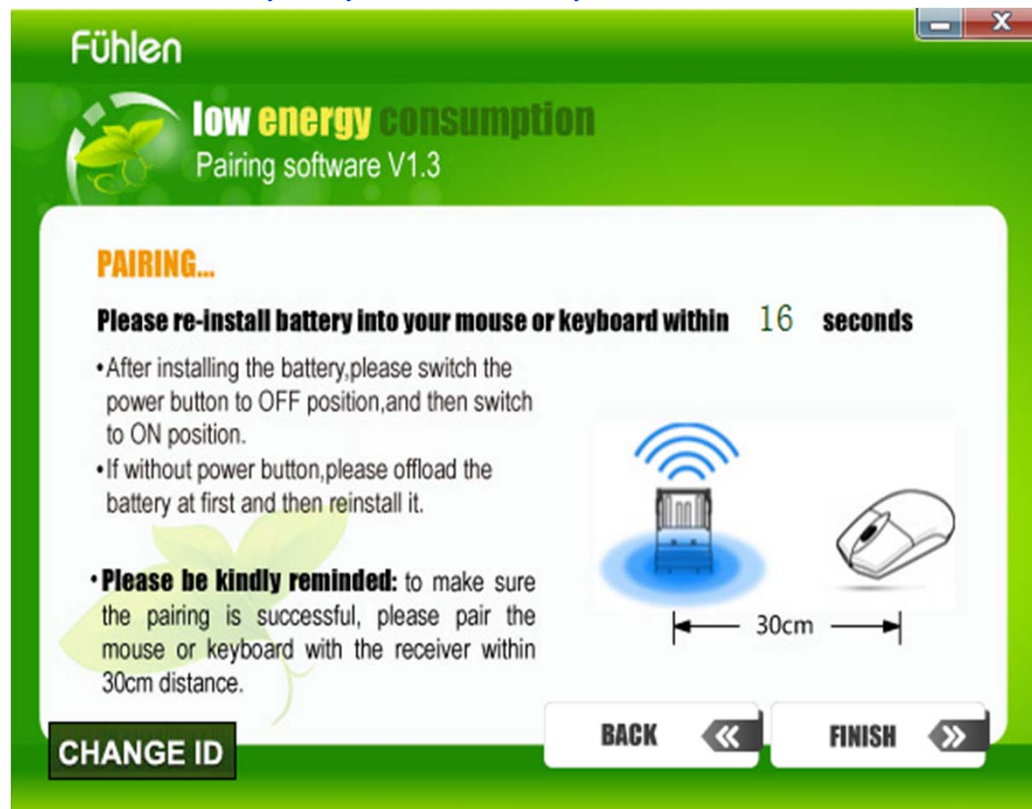

2. Please put your mouse or keyboard near to the receiver within 30cm and re-install the battery into your mouse or keyboard within 20 seconds



3. Then you will get below interface, it means the pairing is successful, you could use the mouse or keyboard now.

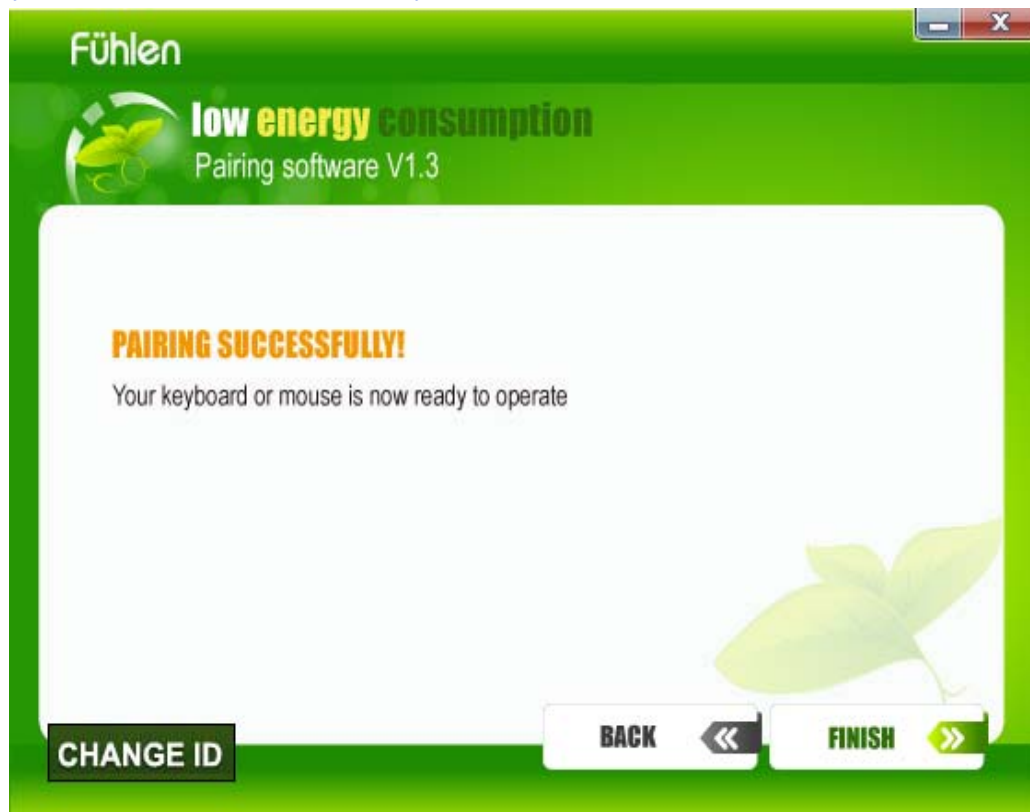

If you get below interface, it means the pairing work is not successful, please click "BACK" and redo from the beginning.

