

GWU627

Universal Wi-Fi N Transmitter - Ethernet to Wi- Fi N



Wi-Fi Ethernet Adapter

Get your Ethernet enabled devices such as Gaming Consoles, Blu-ray™ players, computers or HDTV connected to your wireless home network.

The new IOGEAR Universal Wireless-N Adapter allows you to connect your device such as a Blu-ray player, HDTV, or game console to any Wireless-N network in your home or office. The Wireless-N (IEEE™ 802.11n) Adapter works with any device with an Ethernet port. No need to purchase an USB adapter that only works with a specific brand or device. After configuring the GWU627, simply connect the adapter to your device without worrying about re-wiring your home.

Using dual antennas (1T1R) this product provides data rates up to 150Mbps and reduces Wi-Fi dead zones in your wireless environment. This new standard supplies sufficient bandwidth for faster file transfer, music downloads, video streaming, on-line gaming & HD multi-media applications. In addition to the increased speed and coverage, you will be pleased to know that it is compatible with your existing 802.11b and 802.11g routers and access points. The unit also features a WPS (Wi-Fi Protected Setup™) button offering a quick and secure network setup.

Avoid long stringing cables and enjoy the freedom to place your home entertainment center anywhere and still be connected to the Internet.

- Add High-Speed 802.11n Internet Access to Any Ethernet Enabled Device Such as a Blu-Ray Player, TIVO, HDTV, Game Console or Media PC
- Compatible Network Standards: IEEE 802.11n (Up to 150Mbps) IEEE 802.11g (Up to 54Mbps) IEEE 802.11b (Up to 11Mbps)
- Avoid long stringing cable and enjoy the freedom to access your Ethernet enabled devices wirelessly
- Push-button Wi-Fi Protected Setup™ (WPS) simplifies secure and easy wireless configuration
- Low power requirements allows the device to be powered by an available USB port on the back of your HDTV display
- Wi-Fi N technology improves effective throughput and range over existing 802.11b/g products
- WEP, TKIP, AES, WPA and WPA2 wireless hardware encryption schemes
- Convenient LED status indicator

*Note - Not Compatible with Enterprise Authentication

**Not Compatible with Mesh Networks



How does it work?

- Connect device to Ethernet enabled device via RJ-45 cable

Power the device via an available USB Port or attach to the power adapter

- Wirelessly connect your HDTV, game console, Blu-ray™ and more to your Router*

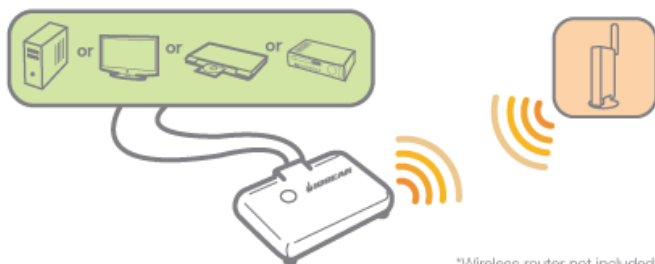

*Wireless router not included

Requirements

Package Contents

- | | |
|--|--|
| <ul style="list-style-type: none"> • Operating System <ul style="list-style-type: none"> ◦ Windows® 10 , Windows® 8 .1, Windows® 8, Windows® 7, Windows Vista® , Windows XP® ◦ Mac OS X v10.4 and above ◦ Linux® Fedora 10 (Kernel: 2.6.27.5-117) • Wireless network with WPS setup • Wireless network without WPS setup and computer • Not recommended for use with enterprise class router (Not Compatible with Enterprise Authentication) | <ul style="list-style-type: none"> • 1 X Universal Wi-Fi Adapter • 1 X USB Power Cable • 1 X Power Adapter • 1 X Ethernet Cable • 1 X Quick Start Guide • 1 x Warranty / Registration Card |
|--|--|

Specifications

Function	GWU627
Power Consumption	Transmit : < 380mA ; Receive: < 250mA.
Operating Temperature	0 ~ 50 celsius
Storage Temperature	-10 ~ 70 celsius
USB Specification	USB 2.0
Humidity	5 ~ 90% (non-condensing)
Transmission Power	17 dBm
Frequency Band	2.4GHz ~ 2.483GHz unlicensed ISM band
Modulation	IEEE 802.11n: BPSK, QPSK, 16-QAM, 64-QAM
Data Rate	IEEE 802.11n : 6, 9, 12, 18, 24, 36, 48, 54, 60, 90, 120 and up to 150Mbps
Interface	USB 2.0
Security	64-bit or 128-bit WEP/WPA TKIP
Management	Windows-based Utility
Operating Range	Indoor up to 100 meters, Outdoor up to 280 meters
Encryption	64 bit / 128 bit WEP, TKIP, AES
Antenna Type	Internal Antenna

Dimensions	GWU627
Unit Dimensions	
Width	2 7/8"
Height	5/8"
Depth	2"
Unit Package Dimensions	
Width	6.25"
Height	7.5"
Depth	2.25"
Weight	
Master Carton Wt.	10.72 lb
Inner Pack Wt.	4.56 lb
Unit Pack Wt.	0.62lb
Unit Wt.	0.08lbs