

GCS24U

4-Port USB Cable KVM Switch



4-Port USB VGA KVM Cable Switch

IOGEAR's 4-Port USB VGA Cable KVM allows users to share a VGA monitor, a USB mouse, and a USB keyboard between four computers. It is the ideal competitively priced - entry level KVM solution that allow users to multitask with ease.

Straight Forward KVM Solution

This USB VGA KVM switch offers an out-of-box solution with no additional cables needed. The USB KVM cables and remote switch are already built in the switch. Conveniently switch between computers by using the 6ft wired remote switch button. This cable KVM switch does not require a power supply as it is powered through the USB bus connection. The 4-port KVM switch also supports multiple operating systems including Windows, Sun, and Mac. It is entirely plug-n-play solutions with no software to run.

Secure Switching

The 4-port USB VGA KVM switch also offers a cost effective solution to increase security by allowing users to switch between the Internet connected PC and an Intranet connected PC, a way to boost Internet security.

- One USB keyboard, USB mouse, and VGA monitor control four computers
- Max resolution: 2048 x 1536, DDC2B
- Plug-n-Play monitor support
- Molded-in cables to simplify setup
- Compact design features two attached KVM (USB and VGA) cables
- Supports Windows® 7, 8.1, 10, 11, Mac OS® X 9.0+, Linux®, Unix and other USB supported systems
- No software drivers required – simply connect the cables to the computers
- Computer selection via 6 ft remote control cable that can be placed on your desk for easy reach
- Full Mac keyboard support
- Supports programmable mice
- No power adapter required



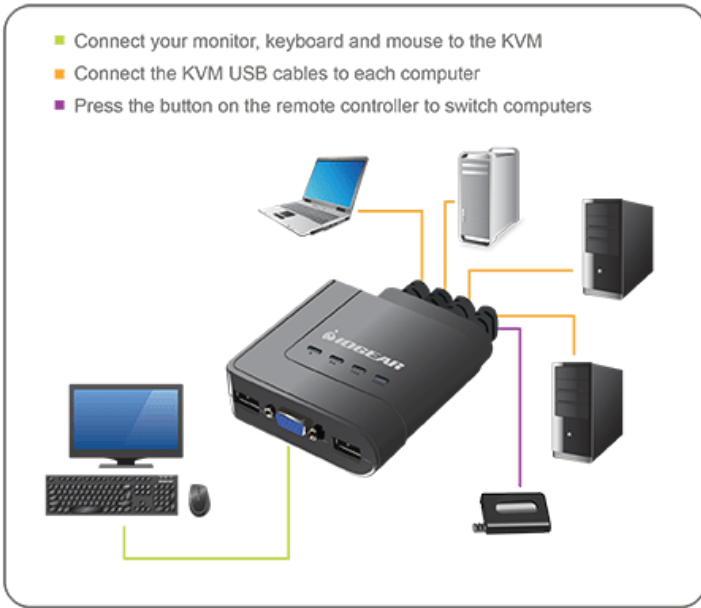

Requirements

Package Contents

Console:

- 1 VGA display
- 1 standard 104 key wired USB keyboard
- 1 standard 2 or 3 button wired USB mouse

- 1 x 4-Port USB Cable KVM
- 1 x Quick Start Guide
- 1 x Warranty Card

Computers:

- 1 VGA port
- 2 USB ports

Operating Systems:

- Windows® 7, 8.1, 10, 11
- Mac OS® X 9.0+
- Linux®, Unix and other USB supported systems*

*Additional drivers and support may be needed

Specifications

Function	GCS24U	Dimensions	GCS24U
Housing		POP Information	
Case	Plastic	10" Peg Hook	3
Console Connectors		6" Peg Hook	2
Monitor	1 x HDB-15 Female	Unit Dimensions	
Keyboard	1 x Type-A Female	Height	7.875in.
Mouse	1 x Type-A Female	Depth	2.375in.
CPU Connectors		Width	6.375in.
Monitor	4 x HDB-15 Male	Unit Package Dimensions	
Keyboard & Mouse	4 x Type-A Male	Height	9.125in.
Switches		Width	6.625in.
Port Selection	Push Button	Depth	3.875in.
Video Resolution	2048x1536, DDC2B	Master Carton	
Cable Length	4ft	Height	7.375in.
Cable Type	Bonded with KVM	Width	9.75in.
Environment		Depth	16in.
Operation Temperature	0C-50C	Master Carton Qty.	6
Storage Temperature	-20C-60C	Weight	
Humidity	0-80% RH, NC	Master Carton Wt.	11.22lb
		Unit Pack Wt.	1.7lb
		Unit Wt.	1.46lb