

GCS1902

2-Port DisplayPort KVMP Switch with USB 3.0 Hub (TAA Compliant)



- Switch between two computers with the push of a button
- Stunning 4K video resolution
- Multiple switching options - via pushbutton, hotkey, or mouse
- 2 x USB 3.0 built-in ports for peripheral sharing
- Cost effective: Cables included, firmware upgradable
- Plug-N-Play

- Control 2 computers using a single keyboard, mouse, and DisplayPort video console
- Superior video quality – 4K UHD (3840x2160 @ 30Hz)
- DisplayPort 1.1 compliant & HDCP compliant
- 2-Port USB 3.0 Hub with SuperSpeed 5Gbps transfer rate
- DP++ supports HDMI and DVI output¹
- Computer selection via front panel pushbuttons, hotkeys, and mouse²
- Independent switching of the KVM, USB, and 2.1 channel audio
- Supports 7.1 HD audio through DisplayPort³
- Mouse emulation or bypass feature supports most mouse drivers and multifunction mice
- Multi-platform support – Windows®7, Windows®8.1, Windows®10, Mac®, and Linux®

- Multilingual keyboard mapping supports English, Japanese, French, and German keyboards
- Mac® keyboard support and emulation⁴
- Auto Scan Mode to monitor all computers
- Power On Detection
- Hot pluggable
- Firmware Upgradable
- All cables included

¹ Dual-Mode DisplayPort (DP++) requires active HDMI and DVI adapters for most display setups.

² Mouse port switching supported alongside mouse emulation mode using a USB 3-button mouse wheel

³ HD audio through DisplayPort cannot be switched independently

⁴ PC keyboard combinations emulate Mac® keyboards. Keyboards only work using their own Operating System



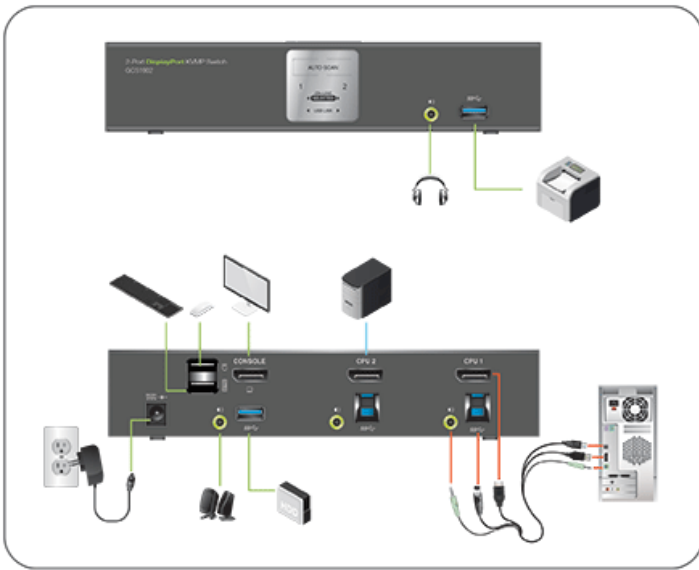

Requirements

Package Contents

- **Console:**
- DisplayPort compatible monitor
- Standard 104 key wired USB keyboard
- Standard 2 or 3 button wired USB mouse
- Speakers (optional)
-
- **Computers:**
- DisplayPort port
- USB Type-A port
- Audio ports (optional)
-
- **Cables:**
- Use only specifically designed IOGEAR DisplayPort KVM Cable sets included

- 1 x GCS1902
- 2 x DisplayPort cables (5ft.)
- 2 x USB 3.0 cables (6ft.)
- 2 x Audio cables (6ft.)
- 1 x Power adapter
- 1 x Manual

*Use with video adapter may change performance

Specifications

Function	GCS1902
Computer Connections	
Direct	2
Port Selection	
	Pushbutton, Hotkeys, Mouse (mouse port switching only works with 3-key USB mouse wheel in emulation mode)
Console Connectors	
Monitor	1 x DisplayPort
Keyboard	1 x USB 3.0 Type A
Mouse	1 x USB 3.0 Type A
Audio	2 x 3.5mm Mini Stereo Jack (Front and Rear)
CPU Connectors	
Monitor	2 x DisplayPort
Audio	2 x 3.5mm Mini Stereo Jack
Keyboard & Mouse	2 x USB 3.0 Type B
Switches	
F/W Upgrade	1 x USB Type B
Port Selection	2 x Pushbutton
Power Connections	
	1 x DC 5V Jack
Connectors	
USB	2 x USB 3.0 Type A (Front and Rear)
LEDs	
Mode	2 x Orange
On Line	2 x Green
KVM	2 x Orange
Audio	2 x Orange
USB Peripherals	2 x Green
Emulation	
Keyboard	USB
Mouse	USB
Video Resolution	
	2560 x 1600 @ 60Hz, 3840 x 2160 @ 30Hz (4K UHD)
Scan Interval	
	1-99 seconds (5 seconds default)
Power	
Voltage	DC 5V
Amps	
Environment	
Operation Temperature	0-50C
Storage Temperature	-20-60C
Humidity	0-80% RH, Non-condensing
Housing	
Case	Metal
Cable Length	
	DisplayPort cables (5ft); USB 3.0 cables (5ft)

Dimensions	GCS1902
Unit Dimensions	
Height	2.94" (7.47cm)
Length	7.875" (20cm)
Depth	1.69" (4.29cm)
Unit Package Dimensions	
Height	6.81" (17.3cm)
Width	11.25" (28.58cm)
Depth	4" (10.16cm)
Master Carton	
Height	14.75" (37.47cm)
Width	12.5" (31.75cm)
Depth	12" (30.48cm)
Master Carton Qty.	6
Weight	
Master Carton Wt.	24.7lb (11.24kg)
Unit Pack Wt.	3.68lb (1.67kg)
Unit Wt.	1.45lb (0.66kg)

at Home at Work on-the-Go

