

GCS1422TAA4C

2-Port Dual View DisplayPort Secure KVM Switch w/Audio and CAC Support



- **NIAP-Certified PP4.0**
Validated to Protection Profile for Peripheral Sharing Device v4.0
- **CAC & Biometrics Support**
Dedicated peripheral port for authorized CAC readers only and supported Biometrics readers¹
- **2-Port Dual View DisplayPort Secure KVM Switch**
One USB console controls 2 secure computers on 2 displays
- **Superior 4K UHD Video Resolution**

2-Port Dual View DisplayPort Secure KVM with Audio and CAC Protection Profile v4.0

Secure and manage multiple data-sensitive systems from one workstation from internal and external cybersecurity threats with the TAA-compliant IOGEAR 2-Port Dual View DisplayPort Secure KVM with Audio and CAC Protection Profile v4.0. Enable authorized users secure access to up to four systems with one keyboard, mouse, up to two 4K @30Hz monitors and dedicated common access card (CAC) reader port.

Featuring the latest in Common Criteria and NIAP Protection Profile v4.0 security requirements set for the U.S. government for peripheral sharing switches, the secure KVM switches are built for multiple interfaces and ideal for use in high-security environments that demand rigorous cybersecurity provisions including military and defense, federal agencies, government, utilities, commercial and healthcare applications.

- NIAP-Certified PP4.0
Validated to Protection Profile for Peripheral Sharing Device v4.0
- CAC & Biometrics Support
Dedicated peripheral port for authorized CAC readers only and supported Biometrics readers¹
- 2-Port Dual View DisplayPort Secure KVM Switch
One USB console controls 2 secure computers on 2 displays
- Superior 4K UHD Video Resolution

UHD Resolution: 3840 x 2160 @30Hz

- Port Selection via Push-Button and Remote Port Selector** for Enhanced Security
Keyboard restrictions - OSD & hotkey methods are not allowed
- Isolated Channel per Port
Unidirectional data flow restricts data leakage between connected computers
- Active Chassis Intrusion Detection
Compromising the unit's cover renders the switch inoperable
- Tamper-Evident Seals
Visually detect attempts to gain access to switch's internal components

- Tamper-Proof Hardware
Integrated circuits are soldered directly onto the circuit board to hinder component sabotage
- Non-Reprogrammable Firmware
Prevents tampering and attempts to reprogram the switch's firmware
- Clears Keyboard Buffer
Data clears automatically after transmission to switch and resets
- Analog Speaker Support
- Secure audio data input does not convert digital audio to analog audio
- Multiplatform Support
Windows® 2000, Vista, 7, 8, 8.1, 10, 11 Linux, Mac OS X, & Sun
- Rugged Metal Enclosure
Durable, Full Metal Chassis
- Build-In, Internal Power Supply

¹Compatible with Microsoft® LifeCam HD-3000 and Microsoft Fingerprint Reader. Please contact your Administrator for CAC and Biometric Reader authorization.

** Remote Port Selector sold separately



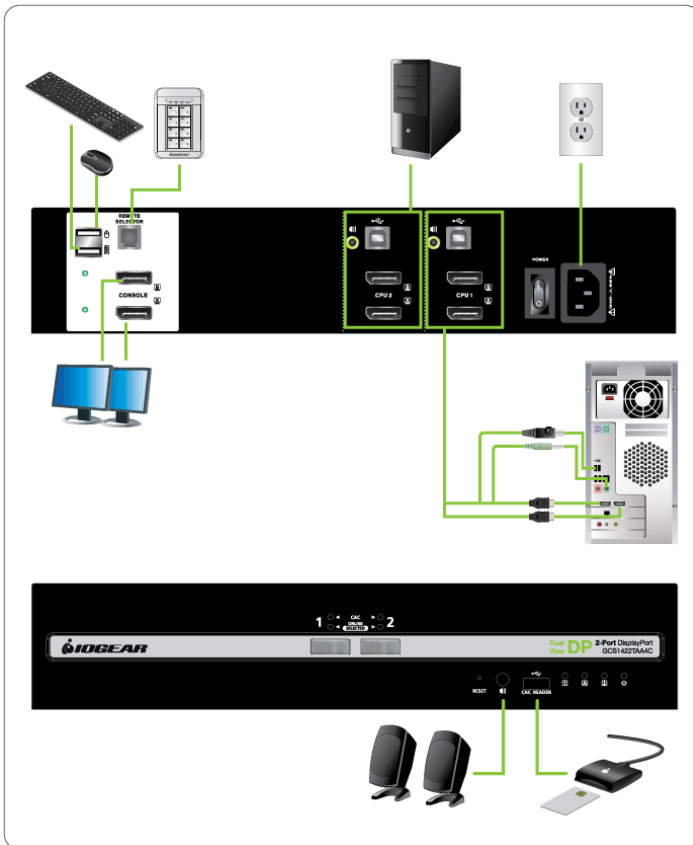

Requirements

Package Contents

Console

- 1x GCS1422TAA4C
 - 1x Power Cord
 - 1x User Guide
 - 1x Warranty Card
- DisplayPort monitors capable of the highest resolution that you will be using on any computer in the installation
 - Standard 104-key wired USB keyboard
 - Standard 2 or 3 button wired USB mouse
 - Speaker (optional)
 - USB Smart card or CAC (Common Access Card) reader (Optional)

Computers

- 2 x DisplayPort Video output connectors
- A USB Type A port for keyboard and mouse
- A USB Type A port for Smart Card or CAC reader (Optional)
- A 3.5mm jack Audio port for speaker (Optional)

Specifications

Function	GCS1422TAA4C
----------	--------------

Computer Connections

Direct	2
--------	---

Port Selection	Pushbutton or Remote Port Selector
-----------------------	------------------------------------

Console Connectors

Monitor	2 x DisplayPort Female
Keyboard	USB Type-A
Mouse	USB Type-A
Audio	1 x 3.5mm Mini Stereo Jack Female
CAC	1x USB Type-A Female

CPU Connectors

Monitor	4 x DisplayPort Female
Keyboard & Mouse	2 x USB Type-B Female
Audio	2 x 3.5 Mini Stereo Jack Female
CAC	2 x USB Type-B Female

Switches

Port Selection	2 x Pushbuttons
Reset	1 x Semi-recessed Pushbutton
Power	1x Rocker

LEDs

On Line	2 x Orange
Selected	2 x Orange
CAC	2 x Green
Power On	1 x Green
Key Lock	3 x Green
Console Video	2 x Green

Emulation

Keyboard	USB
Mouse	USB

Video Resolution	Up to 3840 x 2160@30Hz (UHD)
-------------------------	------------------------------

Power

Input Rating	100 - 240V, 50 - 60Hz; 1A
--------------	---------------------------

Environment

Operation Temperature	0 - 50C
Storage Temperature	-20 - 60C
Humidity	0 - 80% RH, Non-condensing

Housing

Case	Metal
------	-------

Dimensions	GCS1422TAA4C
------------	--------------

Unit Dimensions

Height	2.625" (6.66cm)
Length	6.625" (16.82cm)
Depth	13.25" (33.65cm)

Unit Package Dimensions

Height	9.25" (23.49cm)
Width	16.75" (42.54cm)
Depth	22" (55.88cm)

Master Carton

Height	10.5" (26.67cm)
Width	16.75" (42.54cm)
Depth	22" (55.88cm)
Master Carton Qty.	3

Weight

Master Carton Wt.	22lbs (9.97kg)
Unit Pack Wt.	6.6lbs (2.99kg)
Unit Wt.	4.65lbs (2.10kg)