

GCL1808

## 8-Port 17" LCD Combo KVM Switch



- Integrated 8-port KVM console featuring a 17" TFT LCD active matrix monitor, keyboard and touchpad
- 1280 x 1024 resolution on 17" rack mount LCD provides a sharp video display
- Auto Scan Mode to monitor connected computers
- Broadcast Mode to send commands to all connected computers
- Adjustable depth to fit different sizes of racks

### 8-Port Combo LCD KVM

IOGEAR's 8-Port 17" LCD Combo KVM Switch integrates a 17" LCD console with an 8-port KVM (keyboard, video, and mouse) switch, offering secure access to 8 VGA, USB or PS/2 computers. This 8-Port LCD KVM features a convenient rack mountable sliding / retractable 17" TFT LCD active matrix monitor and keyboard with built-in touchpad for a space-saving and streamlined integration. For added convenience it also supports an external USB mouse. All this in a universal 1U rack mount space.

- Integrated 8-port KVM console featuring a 17" TFT LCD active matrix monitor, keyboard and touchpad
- 1280 x 1024 resolution on 17" rack mount LCD provides a sharp video display
- Auto Scan Mode to monitor connected computers
- Broadcast Mode to send commands to all connected computers
- Adjustable depth to fit different sizes of racks
- Multi platform OS support - Windows®, Mac, Sun Solaris™ , and Linux®
- Easy to operate - computer selection via front panel pushbutton LED's, intuitive OSD (on screen display), and hotkeys
- Auto Scan Mode to monitor all connected computers
- External USB mouse port for convenience
- External USB or PS/2 with VGA Console port
- Support special keys on Mac and Sun keyboards
- USB media port support for attached USB computers (system upgrades, etc) \*\*
- Cascade up to 2 levels - control up to 128 computers from a single console\*
- Security - 2 level password protection for OSD
- DDC Emulation - Video settings of each computer are automatically adjusted for optimal output to the monitor
- Rack mountable in a 19" (1U) system rack
- Firmware upgradeable
- Custom ASIC provides an auto-sensing function that recognizes the position of each station on the installation
- Fully Supports DDC2B

\*Cascade with IOGEAR 8/16-Port VGA Combo KVM Switch (Model No. GCS1808 and GCS1716)

\*\*Only systems connected with the USB KVM cables will be able to access the front USB port for system upgrades and shared peripherals



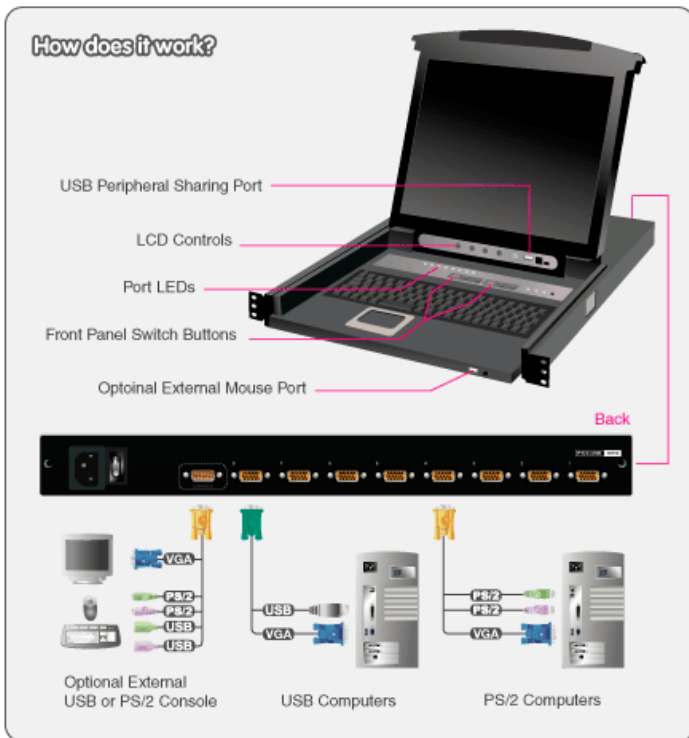

**Requirements**

**Computers:**

- VGA, SVGA, or MultiSync video graphics card with an HDB-15 port
- PS/2 mouse and keyboard ports (6-pin mini DIN) or 1 USB port

**Operating Systems:**

- Windows(R) XP, Windows Vista(R), Windows(R) 7\*, Windows(R) 8, Windows(R) 8.1, Windows 10
  - Mac OS 9 to 10.x
  - Oracle(R) Solaris
  - Linux , Unix and other USB supported systems \*\*
- \*\*Additional drivers and support may be needed  
 \*IOGEAR's DynaSync provides the EDID support for Windows(R) 7

**Package Contents**

- 1 x 8-Port LCD KVM
- 1 x PS/2 KVM Cable
- 1 x USB KVM Cable
- 1 x Console Cable
- 1 x Cascade Cable
- 1 x Firmware Upgrade Cable
- 1 x Rack Mount Kit - Short Bracket( Fits 16 .6~32.2 Inch Depth) and Long Brackets(Fits 26 .8~41.3 Inch Depth)
- 1 x Grounding Wire
- 1 x Power Cord
- 1 x Installation Guide
- 1 x Warranty Card

## Specifications

Function	GCL1808
<b>Computer Connections</b>	
Direct	8
Daisy Chain or Cascading	128
<b>Port Selection</b>	
OSD, Hotkeys, Pushbuttons	
<b>Connectors</b>	
Console	1 x SPHD-18 Male
Power	1 x 3-Prong AC Socket
<b>Console Connectors</b>	
Monitor	1 x HDB-15 Female
Keyboard	PS/2 or USB
Mouse	PS/2 or USB
Extra Mouse	1 x USB Type A Female
Flash ROM Upgrade	1 x RJ-11 Female
<b>CPU Connectors</b>	
Keyboard, Mouse, and Monitor	8 x SPHD-15 Female
<b>Switches</b>	
Reset	1 x Semi-recessed Pushbutton
Power	1 x Rocker Switch
F/W Upgrade	1 x Switch
LCD Adjustment	4 x Pushbutton
LCD Power	1 x LED Pushbutton (Orange)
Port Selection	8 x Pushbutton
<b>LEDs</b>	
On Line	8 (Orange)
Port ID	4 x 7 Segment LED Display (Yellow)
Power On	Dark Green
<b>Emulation</b>	
Keyboard	PS/2, USB
Mouse	PS/2, USB
<b>Video Resolution</b>	
1280 x 1024 @ 75Hz; DDC2B	
<b>Scan Interval</b>	
1-255 Seconds	
<b>Power Input Rating</b>	
Per AC Power Inlet, 50/60Hz	100~240VAC, 50/60Hz, 1A
<b>Power Consumption</b>	
120V, 28W	
<b>Environment</b>	
Operation Temperature	0~40°C
Storage Temperature	-20~60°C
Humidity	0~80% RH; Non-condensing
<b>Housing</b>	
Case	Metal and Plastic

Dimensions	GCL1808
<b>Unit Dimensions</b>	
Height	1.75in.
Depth	25in.
Width	19in.
<b>Unit Package Dimensions</b>	
Height	5.5in.
Width	26.75in.
Depth	28.5in.
<b>Weight</b>	
Unit Pack Wt.	44.03lb
Unit Wt. w/accessories	33.07lb
Unit Wt.	27.78lb